

**August 25 and August 26, 2023
(Friday/Saturday)
Piper Creek Trial Garden
Red Deer, Alberta**

The staging times for the show will be Thursday August 24, 2023 from 6:00 pm - to 10:00 pm and on Friday morning August 25, 2023 from 7:00 am – 1:00 pm. Judging of exhibits will begin at 1:30 pm sharp. Assistance will be provided during staging if required. Flowers will be available for sale on Friday and Saturday but the Flowers and Arrangements from the show won't be available for sale until after 4 pm on Saturday. Entries may not be removed until 4:00 pm on Saturday.

The show will be open to the public on Friday from 3:00 pm to 6:00 pm and Saturday from 10:00 am to 4:00 pm.

A Note from the President

Welcome to the 14th Annual flower show hosted by the Alberta Dahlia & Gladiolus Society. Our Society has grown from an initial ten members to over 70. It is exciting to have more and more people growing and enjoying the beauty of the dahlias and gladiolus. This flower show gives you the opportunity to see the best flowers the exhibitors can produce. All the forms, colors and artistic displays will be represented. Thank you to all the members and volunteers who make this great show possible.

Marilyn McArthur

2023 Show Committee

Judging	Ken Jensen & Deb Hatt
Ribbons and Awards	Eileen Grant
Head Table	Debbie Hatt
Advertising	Mike Walliser/Cathy Fielden
Greeters & Volunteers	Marilyn McArthur
Snacks & coffee for exhibitors	Terri-Lynn Dodd
Quilt display	Shirley Cullum
Photo display	Wendy Kingsmith

Please visit our website

<https://albertadahliaandgladsociety.com/> for our current Executive and further information about the society.

Index

Note from the President	1
Index	2 & 3
General Show Rules	4
Notes for Judges	4
Diagram/Map to the Trial Garden	5
Dahlia forms and sizes	6
Dahlia Head Table Awards	7
Dahlia Special Awards	8
Section 0: AA	9
Section 1: A	10
Section 2: B	11
Section 3: BB	12
Section 4: Miniature Dahlias	13
Section 5: Micro Dahlias	14
Section 5a: Largest & Smallest Dahlia	14
Section 6a: Balls	15
Section 6b: Mini balls	16
Section 6c: Pompons	17
Section 7a: Stellar	18
Section 7b: Waterlily	19
Section 7c: Novelty Double Center	20
Section 8a: Peony	21
Section 8b: Anemone	22
Section 8c: Novelty Open Center	23
Section 9a: Collarette	24
Section 9b: Orchid	25
Section 9c: Orchette	26
Section 9d: Single	27
Section 9e: Mignon Single	28
Section 10: ADS Seedling Bench	29 & 30
Section 11: Dahlia Vases	31
Section 12: Dahlia Baskets	32
Section 13: Memorial Awards	33
Section 14: Dahlia in a Bowl	34

Index Continued

		Page
	Glad Sizes and colors	35
Section 30	Classes 400-500 Single Spike	36
Section 31	Class 300 Single Spike	37
Section 32	Classes 200-100 Single Spike	38
Section 33	Classes 400-500 3 Spikes	39
Section 34	Class 300: 3 Spikes	40
Section 35	Classes 200-100: 3 Spikes	41
Section 36	Glads in a Vase	42
Section 37	Glad Basket	43
Section 38	Western International Glad Classes	44
Section 39	Glad Head Table Awards	45
Section 40	Glad Special Awards	46
Section 41	Photo Contest	47
Section 42	Arrangements: Glads & Dahlias	48

General Show Rules

1. Dahlia and Glad blooms can be obtained from any grower to be exhibited.
2. Dahlia blooms must be shown disbudded and with at least the first set of leaves. Glad spikes must have at least 2 leaves
3. Named varieties will not be disqualified for oversize or undersize.
4. Judges' decision on the awards will be final.
5. No limit to the number of entries in each class, but there must be different varieties.
6. You can use your own containers for dahlias or containers will be provided by the society. Glads should be shown in milk bottles which also will be available to use from the club.
7. Exhibitors are in two categories as follows:
 - **Intermediate exhibitor (Novice) = Green Tags**
Experience in exhibiting in three or fewer shows
 - **Open exhibitor (Experienced) = White Tags**
Experience in exhibiting in more than three shows

For all show tag pick-up, please contact Lorne McArthur (403)346-4902 or Debbie Hatt 403-392-2159 or print off from the website or Facebook.

Notes for the judges:

Judges will judge on color and form categories to give 1st and 2nd place ribbons. Then each form will be judged for the gold ribbon (this would include all colors in that form). An overall winner will be selected from all the gold ribbons and that bloom will receive a Red Rosette.

Diagram/map to the Trial Garden

If lost, call Lorne McArthur 403-346-4902

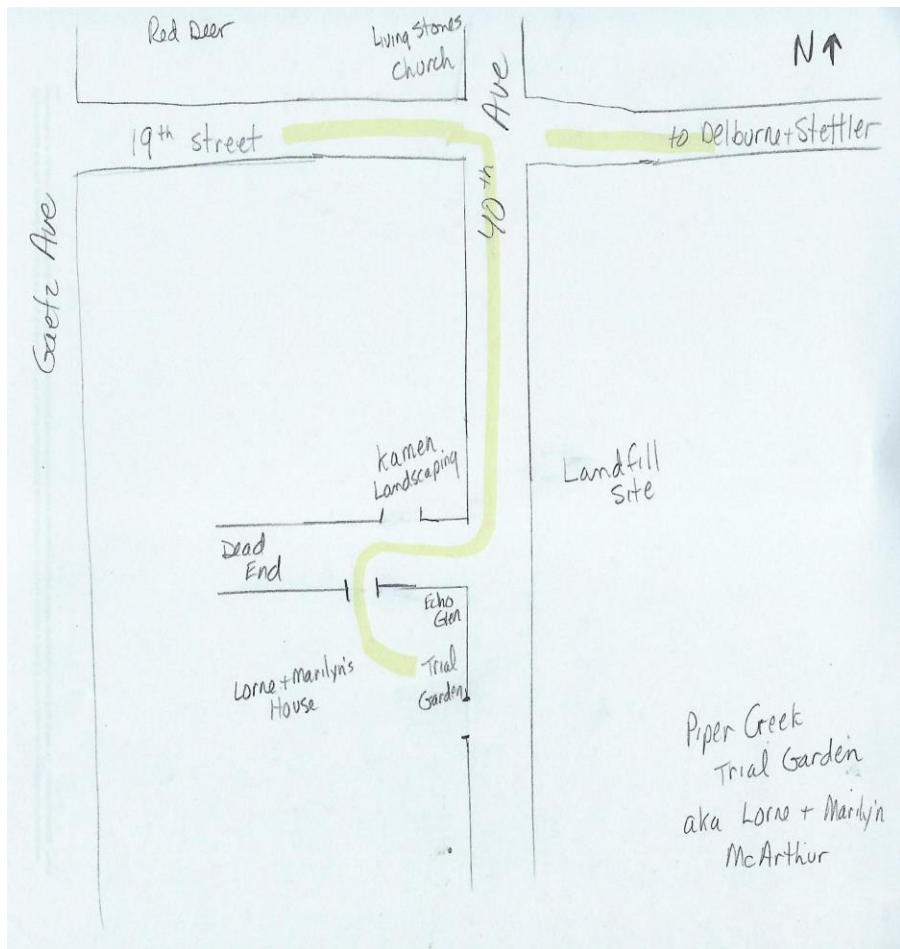

37514 Range Road 273

Red Deer County, Alberta

ABBREVIATIONS FOR FORMS

AN	Anemone-flowered	NO	Novelty open
BA	Ball	NX	Novelty Double
C	Straight Cactus	O	Orchid-flowering
CO	Collarette	P	Pompon
FD	Formal Decorative	PE	Peony-flowering
IC	Incurved Cactus	S	Single
ID	Informal Decorative	SC	Semi-Cactus
LC	Lacinated	ST	Stellar
MB	Miniature Ball	WL	Waterlily
MS	Mignon single	M	Micro

SIZE

AA	over 10" in diameter
A	over 8" to 10" in diameter
B	over 6" to 8" in diameter
BB	over 4" to 6" in diameter
M	up to 4" in diameter
BA	over 3½" in diameter
MB	over 2" to 3½" in diameter
P	up to 2" in diameter
S	over 2" in diameter
MS	up to 2" in diameter
Micro	Less than 2" for all forms except singles which already has a form MS

Dahlia Head Table Awards

(Large Purple Rosette)

Dahlias – Open (Experienced)

1. King of Show - Class AA, A sizes
2. Queen of Show – B, BB sizes
3. Princess of the Show -All other classes
4. Best Triple Bloom
5. Best Vase
6. Best Basket

Dahlias – Intermediate (Novice)

1. King of Show - Class AA, A sizes
2. Queen of Show Class – B, BB sizes
3. Princess of the Show -All other classes
4. Best Triple Bloom
5. Best Vase
6. Best Basket

Purple Rosette – Head Table Award

Red Rosette – Best in class

Gold Ribbon – Best in form

Red Ribbon – 1st place

Blue Ribbon – 2nd place

Dahlia Special Awards

(Red Rosette)

The outstanding exhibit in each category listed below will receive a red rosette ribbon for Open (experienced) AND Intermediate (novice); therefore, there will be a 'Best AA Bloom' for Open entries and a 'Best AA Bloom' for Intermediate entries. Winners remain at the tables (no room at the head table).

Best AA Bloom	Best 3 AA Blooms
Best A Bloom	Best 3 A Blooms
Best B Bloom	Best 3 B Blooms
Best BB Bloom	Best 3 BB Blooms
Best M Bloom	Best 3 M Blooms
Best Ball	Best 3 Balls
Best Mini-Ball	Best 3 Mini-Balls
Best Pompon Bloom	Best 3 Pompon Blooms
Best Stellar Bloom	Best 3 Stellar Blooms
Best Waterlily Bloom	Best 3 Waterlily Blooms
Best Peony Bloom	Best 3 Peony Blooms
Best Anemone Bloom	Best 3 Anemone
Best Collarette Bloom	Best 3 Collarette
Best Single Bloom	Best 3 Single Blooms
Best Mignon Single	Best 3 Mignon Single
Best Orchid Bloom	Best 3 Orchid Blooms
Best Orchette Bloom	Best 3 Orchette Blooms
Best Novelty Open	Best 3 Novelty Open
Best Novelty Double	Best 3 Novelty Double
Best Micro Bloom	Best 3 Micro Blooms
Largest Dahlia	Smallest Dahlia

Memorial Rosettes

Best Arrangement in honor of Vivian Delude incl roses

Best Vase of Red & White dahlias in honor of Jeanne Carter

Best Arrangement of "Alberta" Dahlias in honor of Wayne Roberts

SECTION 0

OPEN to All AA

'AA' Size Bloom: Over 10" (25cm) in diameter

COLOR	FD	ID	SC	C	IC	LC
WHITE	0001	0101	0201	0301	0401	0501
YELLOW	0002	0102	0202	0302	0402	0502
ORANGE	0003	0103	0203	0303	0403	0503
PINK	0004	0104	0204	0304	0404	0504
DARK PINK	0005	0105	0205	0305	0405	0505
RED	0006	0106	0206	0306	0406	0506
DARK RED	0007	0107	0207	0307	0407	0507
LAVENDER	0008	0108	0208	0308	0408	0508
PURPLE	0009	0109	0209	0309	0409	0509
LIGHT BLEND	0010	0110	0210	0310	0410	0510
BRONZE	0011	0111	0211	0311	0411	0511
FLAME	0012	0112	0212	0312	0412	0512
DARK BLEND	0013	0113	0213	0313	0413	0513
VARIEGATED	0014	0114	0214	0314	0414	0514
BI-COLORED	0015	0115	0215	0315	0415	0515
3 Blooms	0016	0116	0216	0316	0416	0516

Entries in each color and form category (potentially 90 categories) will be judged for first and second place ribbons. Each first place in the six forms (Columns above) will be judged to be the best in the form and receive a Gold Ribbon (potentially 6 Gold Ribbons). All the gold ribbons will be judged as a group and ONLY ONE will receive a red rosette for Best 'AA' Bloom.

SECTION 1

OPEN to All A

'A' Size Bloom: 8" - 10" (20cm - 25cm) in diameter

COLOR	FD	ID	SC	C	IC	LC
WHITE	1001	1101	1201	1301	1401	1501
YELLOW	1002	1102	1202	1302	1402	1502
ORANGE	1003	1103	1203	1303	1403	1503
PINK	1004	1104	1204	1304	1404	1504
DARK PINK	1005	1105	1205	1305	1405	1505
RED	1006	1106	1206	1306	1406	1506
DARK RED	1007	1107	1207	1307	1407	1507
LAVENDER	1008	1108	1208	1308	1408	1508
PURPLE	1009	1109	1209	1309	1409	1509
LIGHT BLEND	1010	1110	1210	1310	1410	1510
BRONZE	1011	1111	1211	1311	1411	1511
FLAME	1012	1112	1212	1312	1412	1512
DARK BLEND	1013	1113	1213	1313	1413	1513
VARIEGATED	1014	1114	1214	1314	1414	1514
BI-COLORED	1015	1115	1215	1315	1415	1515
3 Blooms	1016	1116	1216	1316	1416	1516

Entries in each color and form category (potentially 90 categories) will be judged for first and second place ribbons. Each first place in the six forms (Columns above) will be judged to be the best in the form and receive a Gold Ribbon (potentially 6 Gold Ribbons). All the gold ribbons will be judged as a group and ONLY ONE will receive a red rosette for Best 'A' Bloom.

SECTION 2

OPEN to All B

'B' Size Bloom: 6" - 8" (15cm - 20cm) in diameter

COLOR	FD	ID	SC	C	IC	LC
WHITE	2001	2101	2201	2301	2401	2501
YELLOW	2002	2102	2202	2302	2402	2502
ORANGE	2003	2103	2203	2303	2403	2503
PINK	2004	2104	2204	2304	2404	2504
DARK PINK	2005	2105	2205	2305	2405	2505
RED	2006	2106	2206	2306	2406	2506
DARK RED	2007	2107	2207	2307	2407	2507
LAVENDER	2008	2108	2208	2308	2408	2508
PURPLE	2009	2109	2209	2309	2409	2509
LIGHT BLEND	2010	2110	2210	2310	2410	2510
BRONZE	2011	2111	2211	2311	2411	2511
FLAME	2012	2112	2212	2312	2412	2512
DARK BLEND	2013	2113	2213	2313	2413	2513
VARIEGATED	2014	2114	2214	2314	2414	2514
BI-COLORED	2015	2115	2215	2315	2415	2515
3 Blooms	2016	2116	2216	2316	2416	2516

Entries in each color and form category (potentially 90 categories) will be judged for first and second place ribbons. Each first place in the six forms (Columns above) will be judged to be the best in the form and receive a Gold Ribbon (potentially 6 Gold Ribbons). All the gold ribbons will be judged as a group and **ONLY ONE** will receive a red rosette for Best 'B' Bloom.

SECTION 3

OPEN to All BB

'BB' Size Bloom: 4" - 6" (10cm - 15cm) in diameter

COLOR	FD	ID	SC	C	IC	LC
WHITE	3001	3101	3201	3301	3401	3501
YELLOW	3002	3102	3202	3302	3402	3502
ORANGE	3003	3103	3203	3303	3403	3503
PINK	3004	3104	3204	3304	3404	3504
DARK PINK	3005	3105	3205	3305	3405	3505
RED	3006	3106	3206	3306	3406	3506
DARK RED	3007	3107	3207	3307	3407	3507
LAVENDER	3008	3108	3208	3308	3408	3508
PURPLE	3009	3109	3209	3309	3409	3509
LIGHT BLEND	3010	3110	3210	3310	3410	3510
BRONZE	3011	3111	3211	3311	3411	3511
FLAME	3012	3112	3212	3312	3412	3512
DARK BLEND	3013	3113	3213	3313	3413	3513
VARIEGATED	3014	3114	3214	3314	3414	3514
BI-COLORED	3015	3115	3215	3315	3415	3515
3 Blooms	3016	3116	3216	3316	3416	3616

Entries in each color and form category (potentially 90 categories) will be judged for first and second place ribbons. Each first place in the six forms (Columns above) will be judged to be the best in the form and receive a Gold Ribbon (potentially 6 Gold Ribbons). All the gold ribbons will be judged as a group and ONLY one will receive a red rosette for Best 'BB' Bloom.

SECTION 4

Open to All MINIATURE (M)

Miniature Bloom: Under 4" (10cm) in diameter

COLOR	FD	ID	SC	C	IC	LC
WHITE	4001	4101	4201	4301	4401	4501
YELLOW	4002	4102	4202	4302	4402	4502
ORANGE	4003	4103	4203	4303	4403	4503
PINK	4004	4104	4204	4304	4404	4504
DARK PINK	4005	4105	4205	4305	4405	4505
RED	4006	4106	4206	4306	4406	4506
DARK RED	4007	4107	4207	4307	4407	4507
LAVENDER	4008	4108	4208	4308	4408	4508
PURPLE	4009	4109	4209	4309	4409	4509
LIGHT BLEND	4010	4110	4210	4310	4410	4510
BRONZE	4011	4111	4211	4311	4411	4511
FLAME	4012	4112	4212	4312	4412	4512
DARK BLEND	4013	4113	4213	4313	4413	4513
VARIEGATED	4014	4114	4214	4314	4414	4514
BI-COLORED	4015	4115	4215	4315	4415	4515
3 Blooms	4016	4116	4216	4316	4416	4516

Entries in each color and form category (potentially 90 categories) will be judged for first and second place ribbons. Each first place in the six forms (Columns above) will be judged to be the best in the form and receive a Gold Ribbon (potentially 6 Gold Ribbons). All the gold ribbons will be judged as a group and **ONLY TWO** (one for Open and one for Intermediate) will receive a red rosette.

Section 5

Open to all Micro Blooms (not including Pompons)

Single Micro (any form or color)	50
3 Blooms Micro (any form or color)	51

There will be a first and second place in each of these two categories and then the overall winner will receive a Gold Ribbon

Section 5a

Largest and smallest dahlia

Largest Dahlia	52
Smallest Dahlia	53

There will be a first and second place in each of these two categories and then the overall winner will receive a Gold Ribbon. Two classes: Open and Intermediate so two gold ribbons for the Largest Dahlia and two gold ribbons for the Smallest Dahlia. The largest dahlia can also enter for the King of the show or Queen of the show and go to the head table.

SECTION 6a (Ball)

Open to All BALLS

Ball: Over 3.5" (9cm) in diameter

· Three Blooms must be one variety, and in one container

COLOR	1 BLOOM	3 BLOOMS	ADS CLASSIFICATION
WHITE	601	616	6001
YELLOW	602		6002
ORANGE	603		6003
PINK	604		6004
DARK PINK	605		6005
RED	606		6006
DARK RED	607		6007
LAVENDER	608		6008
PURPLE	609		6009
LIGHT BLEND	610		6010
BRONZE	611		6011
FLAME	612		6012
DARK BLEND	613		6013
VARIEGATED	614		6014
BI-COLORED	615		6015

Entries in each color and each category; single bloom or 3 blooms, (potentially 30 categories), will be judged for first and second place ribbons. Each first place in the two categories (1 Bloom or 3 Blooms) will be judged to be the best in the category and receive a Gold Ribbon (2 Gold Ribbons, one for 1-Bloom and one for 3-Blooms. All the gold ribbons will be judged as a group and ONLY TWO (one for Open and one for Intermediate) will receive a red rosette.

SECTION 6b (Mini-ball)

Open to All MINIATURE BALL

Miniature Balls: 2" - 3.5" (5cm - 9cm) in diameter

· Three Blooms must be one variety, and in one container

COLOR	1 BLOOM	3 BLOOMS	ADS CLASSIFICATION
WHITE	617	632	6101
YELLOW	618		6102
ORANGE	619		6103
PINK	620		6104
DARK PINK	621		6105
RED	622		6106
DARK RED	623		6107
LAVENDER	624		6108
PURPLE	625		6109
LIGHT BLEND	626		6110
BRONZE	627		6111
FLAME	628		6112
DARK BLEND	629		6113
VARIEGATED	630		6114
BI-COLORED	631		6115

Entries in each color and each category; single bloom or 3 blooms, (potentially 30 categories), will be judged for first and second place ribbons. Each first place in the two categories (1 Bloom or 3 Blooms) will be judged to be the best in the category and receive a Gold Ribbon (2 Gold Ribbons total). All the gold ribbons will be judged as a group and ONLY TWO (one for Open and one for Intermediate) will receive a red rosette. All entries stay at the display table. (No room at the winner's table). The Triple blooms will be judged again for the head table award.

SECTION 6c (Pompon)

Open to All POMPON

Pompons: Up to 2” (5cm) in diameter

· Three Blooms must be one variety, and in one container

COLOR	1 BLOOM	3 BLOOMS	ADS CLASSIFICATION
WHITE	633	648	6201
YELLOW	634		6202
ORANGE	635		6203
PINK	636		6204
DARK PINK	637		6205
RED	638		6206
DARK RED	639		6207
LAVENDER	640		6208
PURPLE	641		6209
LIGHT BLEND	642		6210
BRONZE	643		6211
FLAME	644		6212
DARK BLEND	645		6213
VARIEGATED	646		6214
BI-COLORED	647		6215

Entries in each color and each category; single bloom or 3 blooms, (potentially 30 categories), will be judged for first and second place ribbons. Each first place in the two categories (1 Bloom or 3 Blooms) will be judged to be the best in the category and receive a Gold Ribbon (2 Gold Ribbons total). All the gold ribbons will be judged as a group and ONLY TWO (one for Open and one for Intermediate) will receive a red rosette. All entries stay at the display table. (No room at the winner's table). The Triple blooms will be judged again for the head table award.

SECTION 7a (Stellar) **Open to All Stellar**

· Three Blooms must be one variety, and in one container

COLOR	1 BLOOM	3 BLOOMS	ADS CLASSIFICATION
WHITE	701	716	7001
YELLOW	702		7002
ORANGE	703		7003
PINK	704		7004
DARK PINK	705		7005
RED	706		7006
DARK RED	707		7007
LAVENDER	708		7008
PURPLE	709		7009
LIGHT BLEND	710		7010
BRONZE	711		7011
FLAME	712		7012
DARK BLEND	713		7013
VARIEGATED	714		7014
BI-COLORED	715		7015

Entries in each color and each category; single bloom or 3 blooms, (potentially 30 categories), will be judged for first and second place ribbons. Each first place in the two categories (1 Bloom or 3 Blooms) will be judged to be the best in the category and receive a Gold Ribbon (2 Gold Ribbons total). All the gold ribbons will be judged as a group and **ONLY TWO** (one for Open and one for Intermediate) will receive a red rosette. All entries stay at the display table. (No room at the winner's table). The Triple blooms will be judged again for the head table award.

Section 7b (Waterlily)

Open to All WATERLILY

· Three Blooms must be one variety, and in one container

COLOR	1 BLOOM	3 BLOOMS	ADS CLASSIFICATION
WHITE	731	746	7301
YELLOW	732		7302
ORANGE	733		7303
PINK	734		7304
DARK PINK	735		7305
RED	736		7306
DARK RED	737		7307
LAVENDER	738		7308
PURPLE	739		7309
LIGHT BLEND	740		7310
BRONZE	741		7311
FLAME	742		7312
DARK BLEND	743		7313
VARIEGATED	744		7314
BI-COLORED	745		7315

Entries in each color and each category; single bloom or 3 blooms, (potentially 30 categories), will be judged for first and second place ribbons. Each first place in the two categories (1 Bloom or 3 Blooms) will be judged to be the best in the category and receive a Gold Ribbon (2 Gold Ribbons total). All the gold ribbons will be judged as a group and ONLY TWO (one for Open and one for Intermediate) will receive a red rosette. All entries stay at the display table. (No room at the winner's table). The Triple blooms will be judged again for the head table award.

SECTION 7c (Novelty Double Center)

Open to all Novelty Double Center (NX)

· Three Blooms must be one variety, and in one container

COLOR	1 BLOOM	3 BLOOMS	ADS CLASSIFICATION
WHITE	761	776	7601
YELLOW	762		7602
ORANGE	763		7603
PINK	764		7604
DARK PINK	765		7605
RED	766		7606
DARK RED	767		7607
LAVENDER	768		7608
PURPLE	769		7609
LIGHT BLEND	770		7610
BRONZE	771		7611
FLAME	772		7612
DARK BLEND	773		7613
VARIEGATED	774		7614
BI-COLORED	775		7615

Entries in each color and each category; single bloom or 3 blooms, (potentially 30 categories), will be judged for first and second place ribbons. Each first place in the two categories (1 Bloom or 3 Blooms) will be judged to be the best in the category and receive a Gold Ribbon (2 Gold Ribbons total). All the gold ribbons will be judged as a group and **ONLY TWO** (one for Open and one for Intermediate) will receive a red rosette. All entries stay at the display table. (No room at the winner's table). The Triple blooms will be judged again for the head table award.

SECTION 8a (Peony)

Open to all PEONY

- Three Blooms must be one variety, and in one container

COLOR	1 BLOOM	3 BLOOMS	ADS CLASSIFICATION
WHITE	801	816	8001
YELLOW	802		8002
ORANGE	803		8003
PINK	804		8004
DARK PINK	805		8005
RED	806		8006
DARK RED	807		8007
LAVENDER	808		8008
PURPLE	809		8009
LIGHT BLEND	810		8010
BRONZE	811		8011
FLAME	812		8012
DARK BLEND	813		8013
VARIEGATED	814		8014
BI-COLORED	815		8015

Entries in each color and each category; single bloom or 3 blooms, (potentially 30 categories), will be judged for first and second place ribbons. Each first place in the two categories (1 Bloom or 3 Blooms) will be judged to be the best in the category and receive a Gold Ribbon (2 Gold Ribbons total). All the gold ribbons will be judged as a group and ONLY TWO (one for Open and one for Intermediate) will receive a red rosette. All entries stay at the display table. (No room at the winner's table). The Triple blooms will be judged again for the head table award.

SECTION 8b (Anemone)

Open to all Anemone

· Three Blooms must be one variety, and in one container

COLOR	1 BLOOM	3 BLOOMS	ADS CLASSIFICATION
WHITE	821	836	8201
YELLOW	822		8202
ORANGE	823		8203
PINK	824		8204
DARK PINK	825		8205
RED	826		8206
DARK RED	827		8207
LAVENDER	828		8208
PURPLE	829		8209
LIGHT BLEND	830		8210
BRONZE	831		8211
FLAME	832		8212
DARK BLEND	833		8213
VARIEGATED	834		8214
BI-COLORED	835		8215

Entries in each color and each category; single bloom or 3 blooms, (potentially 30 categories), will be judged for first and second place ribbons. Each first place in the two categories (1 Bloom or 3 Blooms) will be judged to be the best in the category and receive a Gold Ribbon (2 Gold Ribbons total). All the gold ribbons will be judged as a group and ONLY TWO (one for Open and one for Intermediate) will receive a red rosette. All entries stay at the display table. (No room at the winner's table). The Triple blooms will be judged again for the head table award.

SECTION 8c (Novelty Open Center)

Novelty Open Center NO

.Three Blooms must be one variety, and in one container

COLOR	1 BLOOM	3 BLOOMS	ADS CLASSIFICATION
WHITE	861	876	8601
YELLOW	862		8602
ORANGE	863		8603
PINK	864		8604
DARK PINK	865		8605
RED	866		8606
DARK RED	867		8607
LAVENDER	868		8608
PURPLE	869		8609
LIGHT BLEND	870		8610
BRONZE	871		8611
FLAME	872		8612
DARK BLEND	873		8613
VARIEGATED	874		8614
BI-COLORED	875		8615

Entries in each color and each category; single bloom or 3 blooms, (potentially 30 categories), will be judged for first and second place ribbons. Each first place in the two categories (1 Bloom or 3 Blooms) will be judged to be the best in the category and receive a Gold Ribbon (2 Gold Ribbons total). All the gold ribbons will be judged as a group and ONLY TWO (one for Open and one for Intermediate) will receive a red rosette. All entries stay at the display table. (No room at the winner's table). The Triple blooms will be judged again for the head table award.

SECTION 9a (Collarette)

Open to all Collarette

· Three Blooms must be one variety, and in one container

COLOR	1 BLOOM	3 BLOOMS	ADS CLASSIFICATION
WHITE	901	916	9001
YELLOW	902		9002
ORANGE	903		9003
PINK	904		9004
DARK PINK	905		9005
RED	906		9006
DARK RED	907		9007
LAVENDER	908		9008
PURPLE	909		9009
LIGHT BLEND	910		9010
BRONZE	911		9011
FLAME	912		9012
DARK BLEND	913		9013
VARIEGATED	914		9014
BI-COLORED	915		9015

Entries in each color and each category; single bloom or 3 blooms, (potentially 30 categories), will be judged for first and second place ribbons. Each first place in the two categories (1 Bloom or 3 Blooms) will be judged to be the best in the category and receive a Gold Ribbon (2 Gold Ribbons total). All the gold ribbons will be judged as a group and ONLY TWO (one for Open and one for Intermediate) will receive a red rosette. All entries stay at the display table. (No room at the winner's table). The Triple blooms will be judged again for the head table award.

SECTION 9b (Orchid)

Open to all Orchid

· Three Blooms must be one variety, and in one container

COLOR	1 BLOOM	3 BLOOMS	ADS CLASSIFICATION
WHITE	921	936	9201
YELLOW	922		9202
ORANGE	923		9203
PINK	924		9204
DARK PINK	925		9205
RED	926		9206
DARK RED	927		9207
LAVENDER	928		9208
PURPLE	929		9209
LIGHT BLEND	930		9210
BRONZE	931		9211
FLAME	932		9212
DARK BLEND	933		9213
VARIEGATED	934		9214
BI-COLORED	935		9215

Entries in each color and each category; single bloom or 3 blooms, (potentially 30 categories), will be judged for first and second place ribbons. Each first place in the two categories (1 Bloom or 3 Blooms) will be judged to be the best in the category and receive a Gold Ribbon (2 Gold Ribbons total). All the gold ribbons will be judged as a group and ONLY TWO (one for Open and one for Intermediate) will receive a red rosette. All entries stay at the display table. (No room at the winner's table). The Triple blooms will be judged again for the head table award.

SECTION 9c (Orchette)

Open to all Orchette

· Three Blooms must be one variety, and in one container

COLOR	1 BLOOM	3 BLOOMS	ADS CLASSIFICATION
WHITE	941	956	9401
YELLOW	942		9402
ORANGE	943		9403
PINK	944		9404
DARK PINK	945		9405
RED	946		9406
DARK RED	947		9407
LAVENDER	948		9408
PURPLE	949		9409
LIGHT BLEND	950		9410
BRONZE	951		9411
FLAME	952		9412
DARK BLEND	953		9413
VARIEGATED	954		9414
BI-COLORED	955		9415

Entries in each color and each category; single bloom or 3 blooms, (potentially 30 categories), will be judged for first and second place ribbons. Each first place in the two categories (1 Bloom or 3 Blooms) will be judged to be the best in the category and receive a Gold Ribbon (2 Gold Ribbons total). All the gold ribbons will be judged as a group and ONLY TWO (one for Open and one for Intermediate) will receive a red rosette. All entries stay at the display table. (No room at the winner's table). The Triple blooms will be judged again for the head table award.

SECTION 9d (Single)

Open to all Single

· Three Blooms must be one variety, and in one container

COLOR	1 BLOOM	3 BLOOMS	ADS CLASSIFICATION
WHITE	961	976	9601
YELLOW	962		9602
ORANGE	963		9603
PINK	964		9604
DARK PINK	965		9605
RED	966		9606
DARK RED	967		9607
LAVENDER	968		9608
PURPLE	969		9609
LIGHT BLEND	970		9610
BRONZE	971		9611
FLAME	972		9612
DARK BLEND	973		9613
VARIEGATED	974		9614
BI-COLORED	975		9615

Entries in each color and each category; single bloom or 3 blooms, (potentially 30 categories), will be judged for first and second place ribbons. Each first place in the two categories (1 Bloom or 3 Blooms) will be judged to be the best in the category and receive a Gold Ribbon (2 Gold Ribbons total). All the gold ribbons will be judged as a group and ONLY TWO (one for Open and one for Intermediate) will receive a red rosette. All entries stay at the display table. (No room at the winner's table). The Triple blooms will be judged again for the head table award.

SECTION 9e (Mignon Single)

Open to all Mignon Single

· Three Blooms must be one variety, and in one container

COLOR	1 BLOOM	3 BLOOMS	ADS CLASSIFICATION
WHITE	971	986	9701
YELLOW	972		9702
ORANGE	973		9703
PINK	974		9704
DARK PINK	975		9705
RED	976		9706
DARK RED	977		9707
LAVENDER	978		9708
PURPLE	979		9709
LIGHT BLEND	980		9710
BRONZE	981		9711
FLAME	982		9712
DARK BLEND	983		9713
VARIEGATED	984		9714
BI-COLORED	985		9715

Entries in each color and each category; single bloom or 3 blooms, (potentially 30 categories), will be judged for first and second place ribbons. Each first place in the two categories (1 Bloom or 3 Blooms) will be judged to be the best in the category and receive a Gold Ribbon (2 Gold Ribbons total). All the gold ribbons will be judged as a group and ONLY TWO (one for Open and one for Intermediate) will receive a red rosette. All entries stay at the display table. (No room at the winner's table). The Triple blooms will be judged again for the head table award.

SECTION 10

ADS Seedling Bench EVALUATION

Open to 1st, 2nd, 3rd and 4th Year Seedlings

A.D.S. Seedling Bench Evaluation

Offered in cooperation with The American Dahlia Society

1. A separate Section identified as the A.D.S. Seedling Section will be provided by the Show Officials. To be eligible for entry in this Section, the variety must be 3 or more years old.
2. No charge for entry in the A.D.S. Seedling Evaluation Section, nor requirement of membership in a local society may be imposed on an exhibitor for entering this class.
3. No variety is eligible for entry in the A.D.S. Seedling Evaluation Section for more than 2 consecutive years, and if entered into this section contrary to this provision, its most recent scores will be discarded.
4. If any entry receives a score of 85 points or more, it must be named immediately in accordance with the rules of the Classification Committee as outlined in Article IX, Section 8, Clause 2 of the BYLAWS of the American Dahlia Society, Inc.
5. Name and address of the originator and name or number of the variety must appear legibly on the entry tag.
6. Not more than one entry of a variety may be made, but there is no limit on the number of varieties that may be entered. Varieties entered may be grown by the originator or his representative.
7. All entries must be judged by at least two Senior A.D.S. Judges, and not more than two Accredited A.D.S. Judges, provided that at least three judges participate in scoring of each variety, and that the number of Senior A.D.S. Judges outnumbers the Accredited A.D.S. Judges.
8. If a variety shows evidence of disease or if in the opinion of the Judges an entry is not deemed worthy, it should be eliminated from scoring. A notation on the entry tag should be made as to why the entry was not scored.
9. Judges' scores, which vary by 3 points or more from the average of the scores of the majority of judges, either higher or lower, must be discarded and the average of the remaining scores will prevail.
10. No exhibitor in the section may judge an entry.

SECTION 10

(CONTINUED)

Open to 1st 2nd 3rd and 4th + Year Seedlings

11. Each entry scoring 85 points or more will receive an A.D.S. Seedling Award Ribbon.
12. The entry with the highest average of any variety over 85 points will receive an A.D.S. Achievement Award Ribbon. In case of a tie, the judges must decide which variety possesses the greatest and most outstanding distinction over similar standard varieties.
13. The Chairman of the A.D.S. Seedling Evaluation will annually certify to originators the score, or scores achieved by their dahlias during the current year bench evaluation.
14. A Gold Medal Certificate will be presented to the originators of those varieties which have received three scores of 85 points or more in bench scoring at shows held by three different societies and 85 points or more in three different trial grounds. To be eligible to receive this award, such scores must be earned in a consecutive 2-year period but may be earned in one year.
15. The receipt of the Gold Medal Certificate will be construed as a pledge by the originator to introduce the variety the following year. No certificate will be awarded unless the variety is introduced accordingly. Any variety having scored 85 points or more at one show will be considered a disseminated variety the second year.
16. A LYNN B. DUDLEY MEDAL will be awarded to the GOLD MEDAL CERTIFICATE winner which has the highest average bench score as an A, B, BB, Miniature, or any other type. The highest three scores earned in accordance with the entry under Rule 3, shall be used to determine such highest averages. In the case of ties, duplicate awards will be made.
17. The Seedling Bench Evaluation will proceed under the rules of The American Dahlia Society, Inc. as published in the latest issue of the Classification and Handbook of Dahlias.

Seedlings

Class 796	1st Year	One Bloom
Class 797	2nd & 3rd Year	One Bloom
Class 798	4th Year	3 Blooms/ One Container

SECTION 11

VASES - Dahlias

- VASE - A vessel for displaying flowers. Its height is greater than the diameter of its mouth.
- A vase is judged mainly on the quality of the flowers included, not on the arrangement of the flowers
- Natural foliage may be used
- No oasis, raffia or floral frogs allowed in vase

Class 100	Vase of 5 blooms, 'B' and 'BB' size, any color
Class 102	Vase of any number of blooms, Ball and Min Ball size, any color
Class 103	Vase of any type, excluding above, any number, and any size
Class 104	Mixed vase of 5 dahlias, any size, any color
Class 105	Mixed vase of 6 or more dahlias all one color

Each of the 5 classes receive a first or second ribbon and then all the first-place ribbons will be judged to receive a gold ribbon and go to the head table to receive a red rosette: one for open and one for intermediate. The two winners can stay at the head table.

SECTION 12

BASKETS - Dahlias

- Natural foliage may be used
- Baskets may contain more than one variety
- Baskets judged from one side only
- A floral design is successful when the elements of design are applied to the principles of design producing beauty, harmony, distinction and expression.
- Baskets must have a handle

Class 200	Basket of 'B' or 'BB' size blooms - 7 or more
Class 201	Basket of Mini ball or Ball size blooms - 9 or more
Class 202	Basket of any size blooms, excluding above - any number of blooms (Primarily Dahlias)
Class 203	Basket of any type, any size blooms, any number, other flowers included

Each of the 4 classes receive a first or second ribbon and then all the first-place ribbons will be judged to receive a gold ribbon and go to the head table to receive a red rosette; one for open and one for intermediate. The two winners can stay at the head table.

Section 13

Special Memorial Awards

Class 205	Best arrangement in memory of Vivian Delude. Pink and Red Roses may be added
Class 206	Best vase of red and/or white dahlias in memory of Jeanne Carter
Class 207	Table Centre arrangement using primarily "Alberta" Dahlias in memory of Wayne Roberts

***A Special Rosette will be given to each Special Award winner and the vase or arrangement should stay on the display tables and not the head table.**

Past Memorial Awards (Retired with Love)

- Tony Jensen (Best Zorro)
- Ernie Henderson (Best Regal Rose)
- June Quintilio (Best vase of purple flowers)
- Dave Dillabough (Best glads in an antique container)
- Andy Krajewski (Best Gladiolus, any size or Colour)
- Bill McLaren (any single Alpine bloom)
- Harvey Knutson (Best "Pooh" Dahlia).

SECTION 14

DAHLIA IN A BOWL

- Any size dahlia may be used
- The container may be flat or on a pedestal and viewed from the top, or, if container is clear, from top or side
- No artificial (floral) shall be used
- Unattached foliage may be used
- All dahlias and flowers must be inside the bowl

Class 161	One dahlia in a bowl
Class 162	Three dahlias in a bowl

Winner of each of the two categories receives a gold ribbon, one for open (Experienced) and one for intermediate (Novice). The best of each category will receive a Red Rosette (one for Open and one for Intermediate). These entries stay on the regular tables because we don't have enough room on the head table.

GLADIOLUS CLASSES

Floret Size Classification

100	Miniature	Florets under 2½"
200	Small	Florets 2½" to 3½"
300	Medium	Florets 3½" to 4½"
400	Large	Florets 4½" to 5½"
500	Giant	Florets 5½" or larger

Color Classification

Color	Pale	Light	Medium		
White	00				
Green		02	04	06	
Yellow	10*(1)	12	14	16	
Orange	20*(2)	22	24	26	
Salmon	30	32	34	36	
Pink	40	42	44	46	
Red		52*(4)	54	56	58 Black Red
Rose	60	62	64	66	68 Black Rose
Lavender	70	72	74	76	78 Purple
Violet	80	82	84	86	
Smokies	90	92	94	96	
Tan	90				98 Brown

SECTION 30

GLADS

Class 400-500

Florets 4½" (12cm) and up One Spike

101	White	00 to 01
102	Green	02 to 07
103	Cream	10 to 11
104	Yellow	12 to 17
105	Orange	20 to 27
106	Lt Salmon	30 to 33
107	Dk Salmon	34 to 37
108	Pale to Lt Pink	40 to 43
109	Dk Pink	44 to 47
110	Red	50 to 57
111	Black Red	58 to 59
112	Pale to Med Rose	60 to 65
113	Deep to Dk Rose	66 to 69
114	Lavender	70 to 77
115	Purple	78 to 79
116	Violet	80 to 87
117	Smokey & Brown	90 to 99

Each of the 12 classes receive a first or second ribbon and then all the first-place ribbons will be judged to receive a gold ribbon: one for open (experienced) and one for intermediate (novice). The two winners (Open and intermediate) each also receives a **red rosette**. It stays on the table as we are short of room on the head tables.

SECTION 31

GLADS

Class 300

Florets 3½" - 4½" (9cm-12cm) One Spike

118	White	00 to 01
119	Green, Cream	02 to 11
120	Yellow	12 to 17
121	Orange	20 to 27
122	Salmon	30 to 37
123	Pink	40 to 47
124	Red	50 to 59
125	Rose	60 to 69
126	Lavender	70 to 77
127	Purple, Violet	78 to 87
128	Smokey & Brown	90 to 99

Each of the 11 classes receive a first or second ribbon and then all the first-place ribbons will be judged to receive a gold ribbon: one for open (experienced) and one for intermediate (novice). The two winners (Open and intermediate) each also receives a **red rosette**. It stays on the table as we are short of room on the head tables.

SECTION 32

GLADS

Class 200-100

Florets under 3½" (9cm) One Spike

129	White	00 to 01
130	Green, Cream	02 to 11
131	Yellow	12 to 17
132	Orange	20 to 27
133	Salmon	30 to 37
134	Pink	40 to 47
135	Red	50 to 59
136	Rose	60 to 69
137	Lavender	70 to 77
138	Purple, Violet	78 to 87
139	Smokey & Brown	90 to 99

Each of the 11 classes receive a first or second ribbon and then all the first-place ribbons will be judged to receive a gold ribbon: one for open (experienced) and one for intermediate (novice). The two winners (Open and intermediate) each also receives a **red rosette**. It stays on the table as we are short of room on the head tables.

SECTION 33

GLADS – 3 SPIKES

Class 400-500 - Three Spike, Separate
Containers: Florets 4½" (12cm) and up

144	White	00 to 01
145	Green, Cream	02 to 11
146	Yellow	12 to 17
147	Orange	20 to 27
148	Salmon	30 to 37
149	Pink	40 to 47
150	Red	50 to 59
151	Rose	60 to 69
152	Lavender	70 to 77
153	Purple	78 to 79
154	Violet	80 to 87
155	Smokey & Browns	90 to 99

Each of the 12 classes receive a first or second ribbon and then all the first-place ribbons will be judged to receive a gold ribbon: one for open (experienced) and one for intermediate (novice). All the 3-spike categories winners will be judged against each other for the "Champion 3-Spikes" and receive a Red Rosette.

SECTION 34

GLADS – 3 Spikes

Class 300

Florets 3½" - 4½" (9cm-12cm) Three Spike, Separate Containers

156	White	00 to 01
157	Green, Cream	02 to 11
158	Yellow	12 to 17
159	Orange	20 to 27
160	Salmon	30 to 37
161	Pink	40 to 47
162	Red	50 to 59
163	Rose	60 to 67
164	Lavender	70 to 77
165	Purple	78 to 79
166	Violet	80 to 87
167	Smokey & Brown	90 to 99

Each of the 12 classes receive a first or second ribbon and then all the first-place ribbons will be judged to receive a gold ribbon: one for open (experienced) and one for intermediate (novice). All the 3-spike categories winners will be judged against each other for the "Champion 3-Spikes" and receive a Red Rosette.

SECTION 35

GLADS - 3 Spikes

Class 200-100

Florets under 3½" (9cm) Three Spike, Separate Containers

168	White	00 to 01
169	Green, Cream	02 to 11
170	Yellow	12 to 17
171	Orange	20 to 27
172	Salmon	30 to 37
173	Pink	40 to 47
174	Red	50 to 59
175	Rose	60 to 69
176	Lavender	70 to 77
177	Purple	78 to 79
178	Violet	80 to 87
179	Smokey	90 to 99

Each of the 11 classes receive a first or second ribbon and then all the first-place ribbons will be judged to receive a gold ribbon: one for open (experienced) and one for intermediate (novice). All the 3-spike categories winners will be judged against each other for the "Champion 3-Spikes" and receive a Red Rosette.

SECTION 36

GLAD VASES

Vases

- Natural foliage may be used

Class			
180	Min of 6 spikes	One variety	400 - 500 size
181	Min of 6 spikes	One variety	300 size
182	Min of 6 spikes	One variety	200 - 100 size
183	Any number	Any variety	
184	Mixed glads with any other flowers		

Each of the 5 classes receive a first or second ribbon and then all the first-place ribbons will be judged to receive a gold ribbon: one for open (experienced) and one for intermediate (novice). Best Vase of Glads will receive a red rosette (one for open and one for intermediate) and go to the head table and receive **a large purple Rosette.**

SECTION 37

GLAD BASKETS

- Natural foliage may be used
- Baskets judged from one side only
- A floral design is successful when the elements of design are applied to the principles of design producing beauty, harmony, distinction and expression.
- Baskets must have a handle

Class			
185	Any number	One variety	400 - 500 size
186	Any number	One variety	300 sizes
187	Any number	One variety	200 - 100 size
188	Any number	Any variety	
189	Any number	Any variety with other flowers	

Each of the 5 classes receive a first or second ribbon and then all the first-place ribbons will be judged to receive a gold ribbon: one for open (experienced) and one for intermediate (novice). Best Glad basket will receive a red rosette (one for open and one for intermediate) and receive a **large purple Rosette** but will stay at the table because there won't be enough room at the head table.

Section 38

Western International (For Glad Seedlings only)

Class		
200	Ed Squire's Award*	3-Spike Seedling
201	Large single spike Seedling	300 - 500 size
202	Small single spike Seedling	200 - 100 size

* Note: the winning entry must score 85 to qualify for the award

Recent Introductions

Class		
203	Large single spike	300, 400, 500
204	Miniature Spike	200 - 100 size

Single Spike Originated in Canada

205	Any size single spike Originated in Canada
-----	--

All American and All American Select

Class		
206	Best AA Spike	Any size

The "All American" and "All American Select" are classes where all the spikes grown in the many trial gardens across North America are judged and must score at least 85 to qualify. We (ADGS) have several glad varieties in our Trial Garden in this class. There will be no actual 'spike' entries in this category for the show because the glads are still growing in the trial gardens and will be scored later in the season but you are encouraged to have a look at our entries in the Trial Garden.

Section 39

Gladiolus Head Table Awards

(Large Purple Rosettes)

Open and Intermediate Classes

(One Rosette for Open and one Rosette for Intermediate)

1. Champion spike (400-500) size
2. Champion spike (300) size
3. Champion (100-200) size
4. Champion 3 spikes (any size)
5. Glad Vase
6. Glad Basket

The champion spikes for the head table (large purple rosettes) can also be chosen from the categories for 3 spikes, vases, and/or baskets.

Exhibition Spike vs Decorative Spike

Exhibition Spikes and Decorative Spikes are two separate Divisions, each Division having its unique governing Score Sheet. For example: Grooming and Structure of the spike is of greatest importance in the Exhibition Division of the Handbook where the spike is being scrutinized heavily for Structure. In the Decorative Division, Beauty and Appeal is of greatest importance, with less importance placed on Grooming and Structure. **For this show exhibition and decorative spikes will be judged as one category.**

Section 40

Gladiolus Special Awards

(Small Red Rosettes)

Open (Novice) Green Tags

1. Best Large Spike (400-500) size
2. Best Medium Spike (300) size
3. Best Small Spike (100-200) size
4. Best 3 Spikes (400-500) size
5. Best 3 Spikes (300) size
6. Best 3 Spikes (100-200) size
7. Champion Vase of Glads (Section 37)
8. Champion Basket of Glads (Section 38)
9. Best Single Spike Originated in Canada

Intermediate (Experienced) White Tags

1. Best Large Spike (400-500) size
2. Best Medium Spike (300) size
3. Best Small Spike (100-200) size
4. Best 3 Spikes (400-500) size
5. Best 3 Spikes (300) size
6. Best 3 Spikes (100-200) size
7. Champion Vase of Glads (Section 37)
8. Champion Basket of Glads (Section 38)
9. Best Single Spike Originated in Canada

SECTION 41

PHOTO CONTEST

We had a photo display/contest in our show in 2021 and everyone seemed to like looking at the photos, so we decided to continue it. Some of these photos were shown (and won awards) at the NAGC conference in Atlanta, Georgia in March 2023. Photos 5x7 size can be emailed to Wendy Kingsmith uau7@telus.net before August 15, 2023 or given to her at the show. There will be an overall people's choice award and ribbons for each category.

Class 1	The Glad Patch
Class 2	Undisseminated Seedlings (not named yet)
Class 3	Macro View – Glad (very close-up)
Class 4	Glads or dahlias and Children
Class 5	Glads or dahlias and Critters
Class 6	At the Show – Glads or Dahlias
Class 7	Glad or Dahlia Personalities (People)
Class 8	Glad or Dahlia Occasions
Class 9	Dahlia Portrait (single or arrangement)
Class 10	Macro – Dahlia (very close-up)
Class 11	Dahlias in the Garden
Class 12	Dahlia – Artistic Impression (altering the photo by using digital photoshop)

SECTION 42

ARRANGEMENTS (Primarily Dahlias)

Class 300	Salute to Indigenous Culture
Class 301	Table center arrangement using dahlias
Class 302	Arrangement using dahlias developed in Alberta
Class 303	Salute to farmers; novelty arrangement.
Class 304	Arrangement (your choice) using only mignon dahlias.

ARRANGEMENTS (Primarily Glads) Any Style

Class 305	Fall arrangement including fruits and vegetables
Class 306	Tribute to RCMP any type of arrangement
Class 307	Buffet arrangement using glads.
Class 308	Rocky Mountain High
Class 309	Forest Fires and tribute to fire fighters

Each of the 10 classes receive a first or second ribbon and then all the first-place ribbons will be judged to receive a gold ribbon. Judges will determine the best of all the gold ribbons and the winner will receive a Purple Rosette. Due to lack of room at the head table the winner of the Purple Rosette will remain on the display table. **In this class (Artistic Arrangements) open and intermediate are judged together (only one Purple Rosette).**