

August 20 and August 21, 2021 (Friday/Saturday)
Piper Creek Trial Garden
Lorne & Marilyn McArthur
Red Deer, Alberta

The staging times for the show will be Thursday August 19, 2021 from 6:00 pm - to 10:00 pm and on Friday morning August 20, 2021 from 7:00 am - 11:00 am. Judging of exhibits will begin at 11:00 am sharp. Assistance will be provided during staging. Entries may not be removed until 3:00 pm on Sunday.

A Note from the President

The Annual Alberta Dahlia and Glad Society Flower Show for 2021 is at our Trial Garden in Red Deer. This is the twelfth annual show and once again the most beautiful and colourful dahlias and gladiolus from Alberta are brought together for public viewing. Even into mid-June we were not exactly sure that the Covid Pandemic was truly over, so we decided to have the show at the Trial Garden (as we did last year) instead of an inside venue to avoid close indoor physical contact. Putting on a show is a labor of love and we hope you love seeing the blooms and enjoying the social aspect of the show as much as we do!

Marilyn McArthur

2021 Show Committee

| | |
|---|-----------------------------------|
| Judging | Ken Jensen |
| Ribbons and Awards | Eileen Grant |
| Head Table | Ken, Earl, Eileen |
| Volunteers | Marilyn McArthur |
| Advertising | Deb Hatt & Marg Rumsey |
| Information and Membership | Rotating shifts |
| Snacks & coffee for exhibitors | Shirley Cullum |

****We may have an evening supper at a restaurant on Friday**

Please visit our website <https://albertadahliaandgladsociety.com/> for our current Executive and further information about the society.

Index

| | |
|---------------------------------|---------|
| Note from the President | 1 |
| Index | 2 & 3 |
| General Show Rules | 4 |
| Notes for Judges | 4 |
| Diagram/Map to the Trial Garden | 5 |
| Dahlia forms and sizes | 6 |
| Dahlia Head Table Awards | 7 |
| Dahlia Special Awards | 8 |
| Section 1: AA | 9 |
| Section 2: A | 10 |
| Section 3: B | 11 |
| Section 4: BB | 12 |
| Section 5: M | 13 |
| Section 6: Dahlia Multiples | 14 |
| Section 7: Balls | 15 |
| Section 8: Mini-balls | 16 |
| Section 9: Pompons | 17 |
| Section 10: Stellar | 18 |
| Section 11: Waterlily | 19 |
| Section 12: Peony | 20 |
| Section 13: Anemone | 21 |
| Section 14: Novelty Open Center | 22 |
| Section 15: Collarette | 23 |
| Section 16: Orchid | 24 |
| Section 17: Orchette | 25 |
| Section 18: Single | 26 |
| Section 19: Mignon Single | 27 |
| Section 20: Novelty Double | 28 |
| Section 21: Micro Bloom | 29 |
| Section 22: ADS Seedling Bench | 30 & 31 |
| Section 23: Dahlia Vases | 32 |
| Section 24: Dahlia Baskets | 33 |
| Section 25: Memorial Awards | 34 |
| Section 26: Dahlia Arrangements | 35 |
| Section 27: Dahlia in a Bowl | 36 |

Index Continued

Gladiolus size and colors

| | |
|--|----|
| Section 28: Classes 400-500 Single Spike | 38 |
| Section 29: Class 300 Single Spike | 39 |
| Section 30: Classes 200-100 Single Spike | 40 |
| Section 31: Glad Seedlings | 41 |
| Section 32: Class 400-500 3 spikes | 42 |
| Section 33: Class 300 3 spikes | 43 |
| Section 34: Class 200-100 3 spikes | 44 |
| Section 35: Glads in a vase | 45 |
| Section 36: Glad Basket | 46 |
| Section 37: Glad Arrangements | 47 |
| Section 38: Western International Glad Classes | 48 |
| Glad Head Table Awards | 49 |
| Glad Special Awards | 50 |
| Section 39: NAGC Photo Contest | 51 |

General Show Rules

1. Dahlia and Glad blooms can be obtained by any grower to be exhibited.
2. Dahlia blooms must be shown disbudded and with at least the first set of leaves. Glad spikes must have at least 2 leaves
3. Named varieties will not be disqualified for oversize or undersize.
4. Judges' decision on the awards will be final.
5. No limit to the number of entries in each class, but there must be different varieties.
6. You can use your own containers for dahlias or containers will be provided by the society. Glads should be shown in milk bottles which also will be available to use from the club.
7. Exhibitors are in two categories as follows:
 - Intermediate exhibitor = Green Tags
Experience in exhibiting in three or fewer shows
 - Open exhibitor = White Tags
Experience in exhibiting in more than three shows

For all show tag pick-up, please contact Lorne McArthur (403)346-4902 or Debbie Hatt 403-392-2159 or print off from the website or facebook.

Notes for the judges:

Judges will judge on color and form categories to give 1st and 2nd place ribbons. Then each form will be judged for the gold ribbon (this would include all colours in that form). An overall "Gold" will be selected from all the gold ribbons and that bloom will go to the Head Table and from there a Rosette will be awarded to the top entry in each section. The next step in judging is to determine the rosette awards and special awards.

Diagram/map to the Trial Garden

If lost, call Lorne McArthur 403-346-4902

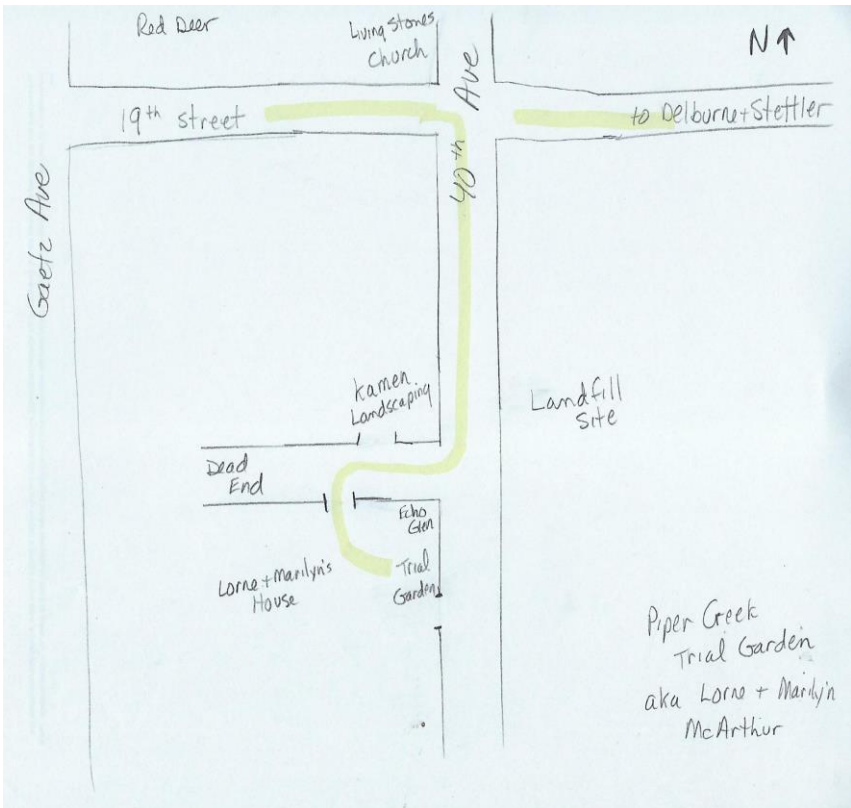

37514 Range Road 273

Red Deer County, Alberta

ABBREVIATIONS FOR FORMS

| | | | |
|-----------|---------------------|-----------|------------------|
| AN | Anemone-flowered | NO | Novelty open |
| BA | Ball | NX | Novelty Double |
| C | Straight Cactus | O | Orchid-flowering |
| CO | Collarette | P | Pompon |
| FD | Formal Decorative | PE | Peony-flowering |
| IC | Incurved Cactus | S | Single |
| ID | Informal Decorative | SC | Semi-Cactus |
| LC | Lacinated | ST | Stellar |
| MB | Miniature Ball | WL | Waterlily |
| MS | Mignon single | M | Micro |

SIZE

| | |
|--------------|---|
| AA | over 10" in diameter |
| A | over 8" to 10" in diameter |
| B | over 6" to 8" in diameter |
| BB | over 4" to 6" in diameter |
| M | up to 4" in diameter |
| BA | over 3½" in diameter |
| MB | over 2" to 3½" in diameter |
| P | up to 2" in diameter |
| S | over 2" in diameter |
| MS | up to 2" in diameter |
| Micro | Less than 2" for all forms except singles which already has a form MS |

Dahlia Head Table Awards

(Large Purple Rosette)

Dahlias - Open

1. The Outstanding Exhibit of the Show
2. King of Show - Class AA - BB
3. Queen of Show - Class M - Novelty Fully Double NX
4. Best Triple Bloom
5. Best Single Dahlia
6. Best Vase
7. Best Basket
8. Best Dahlia in a bowl
9. Best Arrangement
10. Best Seedling

Dahlias – Intermediate

1. The Outstanding Exhibit of the Show
2. King of Show - Class AA - BB
3. Queen of Show - Class M - Novelty Fully Double NX
4. Best Triple Bloom
5. Best Single Dahlia
6. Best Vase
7. Best Basket
8. Best Dahlia in a bowl
9. Best Arrangement
10. Best Seedling

Dahlia Special Awards

(Small Red Rosette)

The outstanding exhibit in each category listed below will receive a rosette ribbon for Open AND Intermediate, therefore there will be a 'Best AA Bloom' for Open entries and a 'Best AA Bloom' for Intermediate entries.

| | |
|----------------------------|------------------------------|
| Best AA Bloom | Best 3 AA Blooms |
| Best A Bloom | Best 3 A Blooms |
| Best B Bloom | Best 3 B Blooms |
| Best BB Bloom | Best 3 BB Blooms |
| Best M Bloom | Best 3 M Blooms |
| Best Pompon Bloom | Best 3 Pompon Blooms |
| Best Stellar Bloom | Best 3 Stellar Blooms |
| Best Waterlily Bloom | Best 3 Waterlily Blooms |
| Best Peony Bloom | Best 3 Peony Blooms |
| Best Anemone Bloom | Best 3 Anemone Blooms |
| Best Collarette Bloom | Best 3 Collarette Blooms |
| Best Single Bloom | Best 3 Single Blooms |
| Best Mignon Single Bloom | Best 3 Mignon Single Blooms |
| Best Orchid Bloom | Best 3 Orchid Blooms |
| Best Orchette Bloom | Best 3 Orchette Blooms |
| Best Novelty Open Centre | Best 3 Novelty Open Blooms |
| Best Novelty Double Centre | Best 3 Novelty Double Blooms |
| Best Micro Bloom | Best 3 Micro Blooms |

Best "Pooh" Single
Best Vase of red/white dahlias
Best "Pandemic" Arrangement (Primarily Dahlias)
Best Arrangement using four forms of dahlias
Best Arrangement with "Alberta" Dahlias
Best Arrangement 'Celebrating Red Deer's
Agricultural Heritage, Your choice flowers.

SECTION 1

OPEN to All AA

'AA' Size Bloom: Over 10" (25cm) in diameter

| COLOR | FD | ID | SC | C | IC | LC |
|--------------|-----------|-----------|-----------|----------|-----------|-----------|
| WHITE | 0001 | 0101 | 0201 | 0301 | 0401 | 0501 |
| YELLOW | 0002 | 0102 | 0202 | 0302 | 0402 | 0502 |
| ORANGE | 0003 | 0103 | 0203 | 0303 | 0403 | 0503 |
| PINK | 0004 | 0104 | 0204 | 0304 | 0404 | 0504 |
| DARK PINK | 0005 | 0105 | 0205 | 0305 | 0405 | 0505 |
| RED | 0006 | 0106 | 0206 | 0306 | 0406 | 0506 |
| DARK RED | 0007 | 0107 | 0207 | 0307 | 0407 | 0507 |
| LAVENDER | 0008 | 0108 | 0208 | 0308 | 0408 | 0508 |
| PURPLE | 0009 | 0109 | 0209 | 0309 | 0409 | 0509 |
| LIGHT BLEND | 0010 | 0110 | 0210 | 0310 | 0410 | 0510 |
| BRONZE | 0011 | 0111 | 0211 | 0311 | 0411 | 0511 |
| FLAME | 0012 | 0112 | 0212 | 0312 | 0412 | 0512 |
| DARK BLEND | 0013 | 0113 | 0213 | 0313 | 0413 | 0513 |
| VARIEGATED | 0014 | 0114 | 0214 | 0314 | 0414 | 0514 |
| BI-COLORED | 0015 | 0115 | 0215 | 0315 | 0415 | 0515 |

Entries in each color and form category (potentially 90 categories) will be judged for first and second place ribbons. Each first place in the six forms (Columns above) will be judged to be the best in the form and receive a Gold Ribbon (potentially 6 Gold Ribbons). All the gold ribbons will be judged as a group and **ONLY ONE** will go to the head table and will receive a red rosette for Best 'AA' Bloom.

SECTION 2

OPEN to All A

'A' Size Bloom: 8" - 10" (20cm - 25cm) in diameter

| COLOR | FD | ID | SC | C | IC | LC |
|--------------|-----------|-----------|-----------|----------|-----------|-----------|
| WHITE | 1001 | 1101 | 1201 | 1301 | 1401 | 1501 |
| YELLOW | 1002 | 1102 | 1202 | 1302 | 1402 | 1502 |
| ORANGE | 1003 | 1103 | 1203 | 1303 | 1403 | 1503 |
| PINK | 1004 | 1104 | 1204 | 1304 | 1404 | 1504 |
| DARK PINK | 1005 | 1105 | 1205 | 1305 | 1405 | 1505 |
| RED | 1006 | 1106 | 1206 | 1306 | 1406 | 1506 |
| DARK RED | 1007 | 1107 | 1207 | 1307 | 1407 | 1507 |
| LAVENDER | 1008 | 1108 | 1208 | 1308 | 1408 | 1508 |
| PURPLE | 1009 | 1109 | 1209 | 1309 | 1409 | 1509 |
| LIGHT BLEND | 1010 | 1110 | 1210 | 1310 | 1410 | 1510 |
| BRONZE | 1011 | 1111 | 1211 | 1311 | 1411 | 1511 |
| FLAME | 1012 | 1112 | 1212 | 1312 | 1412 | 1512 |
| DARK BLEND | 1013 | 1113 | 1213 | 1313 | 1413 | 1513 |
| VARIEGATED | 1014 | 1114 | 1214 | 1314 | 1414 | 1514 |
| BI-COLORED | 1015 | 1115 | 1215 | 1315 | 1415 | 1515 |

Entries in each color and form category (potentially 90 categories) will be judged for first and second place ribbons. Each first place in the six forms (Columns above) will be judged to be the best in the form and receive a Gold Ribbon (potentially 6 Gold Ribbons). All the gold ribbons will be judged as a group and ONLY ONE will go to the head table and will receive a red rosette for Best 'A' Bloom.

SECTION 3

OPEN to All B

'B' Size Bloom: 6" - 8" (15cm - 20cm) in diameter

| COLOR | FD | ID | SC | C | IC | LC |
|--------------|-----------|-----------|-----------|----------|-----------|-----------|
| WHITE | 2001 | 2101 | 2201 | 2301 | 2401 | 2501 |
| YELLOW | 2002 | 2102 | 2202 | 2302 | 2402 | 2502 |
| ORANGE | 2003 | 2103 | 2203 | 2303 | 2403 | 2503 |
| PINK | 2004 | 2104 | 2204 | 2304 | 2404 | 2504 |
| DARK PINK | 2005 | 2105 | 2205 | 2305 | 2405 | 2505 |
| RED | 2006 | 2106 | 2206 | 2306 | 2406 | 2506 |
| DARK RED | 2007 | 2107 | 2207 | 2307 | 2407 | 2507 |
| LAVENDER | 2008 | 2108 | 2208 | 2308 | 2408 | 2508 |
| PURPLE | 2009 | 2109 | 2209 | 2309 | 2409 | 2509 |
| LIGHT BLEND | 2010 | 2110 | 2210 | 2310 | 2410 | 2510 |
| BRONZE | 2011 | 2111 | 2211 | 2311 | 2411 | 2511 |
| FLAME | 2012 | 2112 | 2212 | 2312 | 2412 | 2512 |
| DARK BLEND | 2013 | 2113 | 2213 | 2313 | 2413 | 2513 |
| VARIEGATED | 2014 | 2114 | 2214 | 2314 | 2414 | 2514 |
| BI-COLORED | 2015 | 2115 | 2215 | 2315 | 2415 | 2515 |

Entries in each color and form category (potentially 90 categories) will be judged for first and second place ribbons. Each first place in the six forms (Columns above) will be judged to be the best in the form and receive a Gold Ribbon (potentially 6 Gold Ribbons). All the gold ribbons will be judged as a group and ONLY ONE will go to the head table and will receive a red rosette for Best 'B' Bloom.

SECTION 4

OPEN to All BB

'BB' Size Bloom: 4" - 6" (10cm - 15cm) in diameter

| COLOR | FD | ID | SC | C | IC | LC |
|--------------|-----------|-----------|-----------|----------|-----------|-----------|
| WHITE | 3001 | 3101 | 3201 | 3301 | 3401 | 3501 |
| YELLOW | 3002 | 3102 | 3202 | 3302 | 3402 | 3502 |
| ORANGE | 3003 | 3103 | 3203 | 3303 | 3403 | 3503 |
| PINK | 3004 | 3104 | 3204 | 3304 | 3404 | 3504 |
| DARK PINK | 3005 | 3105 | 3205 | 3305 | 3405 | 3505 |
| RED | 3006 | 3106 | 3206 | 3306 | 3406 | 3506 |
| DARK RED | 3007 | 3107 | 3207 | 3307 | 3407 | 3507 |
| LAVENDER | 3008 | 3108 | 3208 | 3308 | 3408 | 3508 |
| PURPLE | 3009 | 3109 | 3209 | 3309 | 3409 | 3509 |
| LIGHT BLEND | 3010 | 3110 | 3210 | 3310 | 3410 | 3510 |
| BRONZE | 3011 | 3111 | 3211 | 3311 | 3411 | 3511 |
| FLAME | 3012 | 3112 | 3212 | 3312 | 3412 | 3512 |
| DARK BLEND | 3013 | 3113 | 3213 | 3313 | 3413 | 3513 |
| VARIEGATED | 3014 | 3114 | 3214 | 3314 | 3414 | 3514 |
| BI-COLORED | 3015 | 3115 | 3215 | 3315 | 3415 | 3515 |

Entries in each color and form category (potentially 90 categories) will be judged for first and second place ribbons. Each first place in the six forms (Columns above) will be judged to be the best in the form and receive a Gold Ribbon (potentially 6 Gold Ribbons). All the gold ribbons will be judged as a group and ONLY ONE will go to the head table and will receive a red rosette for Best 'BB' Bloom.

SECTION 5

Open to All MINIATURE

Miniature Bloom: Under 4" (10cm) in diameter

| COLOR | FD | ID | SC | C | IC | LC |
|--------------|-----------|-----------|-----------|----------|-----------|-----------|
| WHITE | 4001 | 4101 | 4201 | 4301 | 4401 | 4501 |
| YELLOW | 4002 | 4102 | 4202 | 4302 | 4402 | 4502 |
| ORANGE | 4003 | 4103 | 4203 | 4303 | 4403 | 4503 |
| PINK | 4004 | 4104 | 4204 | 4304 | 4404 | 4504 |
| DARK PINK | 4005 | 4105 | 4205 | 4305 | 4405 | 4505 |
| RED | 4006 | 4106 | 4206 | 4306 | 4406 | 4506 |
| DARK RED | 4007 | 4107 | 4207 | 4307 | 4407 | 4507 |
| LAVENDER | 4008 | 4108 | 4208 | 4308 | 4408 | 4508 |
| PURPLE | 4009 | 4109 | 4209 | 4309 | 4409 | 4509 |
| LIGHT BLEND | 4010 | 4110 | 4210 | 4310 | 4410 | 4510 |
| BRONZE | 4011 | 4111 | 4211 | 4311 | 4411 | 4511 |
| FLAME | 4012 | 4112 | 4212 | 4312 | 4412 | 4512 |
| DARK BLEND | 4013 | 4113 | 4213 | 4313 | 4413 | 4513 |
| VARIEGATED | 4014 | 4114 | 4214 | 4314 | 4414 | 4514 |
| BI-COLORED | 4015 | 4115 | 4215 | 4315 | 4415 | 4515 |

Entries in each color and form category (potentially 90 categories) will be judged for first and second place ribbons. Each first place in the six forms (Columns above) will be judged to be the best in the form and receive a Gold Ribbon (potentially 6 Gold Ribbons). All the gold ribbons will be judged as a group and ONLY ONE will go to the head table and will receive a red rosette for Best 'M' Bloom.

SECTION 6

Open to All MULTIPLE BLOOMS

AA, A, B, BB, M

· Three blooms must be one variety, same colour, and in one container

| AA SIZE BLOOMS | FD | ID | SC | C | IC | LC |
|-----------------------|-----------|-----------|-----------|----------|-----------|-----------|
| 3 BLOOMS | 340 | 341 | 342 | 343 | 344 | 345 |
| | | | | | | |
| A SIZE BLOOMS | FD | ID | SC | C | IC | LC |
| 3 BLOOMS | 346 | 347 | 348 | 349 | 350 | 351 |
| | | | | | | |
| B SIZE BLOOMS | FD | ID | SC | C | IC | LC |
| 3 BLOOMS | 352 | 353 | 354 | 355 | 356 | 357 |
| | | | | | | |
| BB SIZE BLOOMS | FD | ID | SC | C | IC | LC |
| 3 BLOOMS | 358 | 359 | 360 | 361 | 362 | 363 |
| | | | | | | |
| M SIZE BLOOMS | FD | ID | SC | C | IC | LC |
| 3 BLOOMS | 364 | 365 | 366 | 367 | 368 | 369 |

Entries in each size and form category (potentially 30 categories) will be judged for first and second place ribbons. Each first place in the six forms (Rows above) will be judged to be the best in the form and receive a Gold Ribbon (potentially 5 Gold Ribbons) and each gold ribbon will go to the head table and will receive a red rosette for Best "Multiple" Blooms in the form.

SECTION 7

Open to All BALL

Ball: Over 3.5" (9cm) in diameter

· Three Blooms must be one variety, and in one container

| COLOR | 1 BLOOM | 3 BLOOMS | ADS CLASSIFICATION |
|--------------|----------------|-----------------|---------------------------|
| WHITE | 601 | 616 | 6001 |
| YELLOW | 602 | | 6002 |
| ORANGE | 603 | | 6003 |
| PINK | 604 | | 6004 |
| DARK PINK | 605 | | 6005 |
| RED | 606 | | 6006 |
| DARK RED | 607 | | 6007 |
| LAVENDER | 608 | | 6008 |
| PURPLE | 609 | | 6009 |
| LIGHT BLEND | 610 | | 6010 |
| BRONZE | 611 | | 6011 |
| FLAME | 612 | | 6012 |
| DARK BLEND | 613 | | 6013 |
| VARIEGATED | 614 | | 6014 |
| BI-COLORED | 615 | | 6015 |

Entries in each color and each category; single bloom or 3 blooms, (potentially 30 categories), will be judged for first and second place ribbons. Each first place in the two categories (1 Bloom or 3 Blooms) will be judged to be the best in the category and receive a Gold Ribbon (2 Gold Ribbons). Both gold ribbons will go to the head table and will receive a Red Rosette for Best Single or Best 3 blooms.

SECTION 8

Open to All MINIATURE BALL

Miniature Balls: 2" - 3.5" (5cm - 9cm) in diameter

· Three Blooms must be one variety, and in one container

| COLOR | 1 BLOOM | 3 BLOOMS | ADS CLASSIFICATION |
|--------------|----------------|-----------------|---------------------------|
| WHITE | 611 | 626 | 6101 |
| YELLOW | 612 | | 6102 |
| ORANGE | 613 | | 6103 |
| PINK | 614 | | 6104 |
| DARK PINK | 615 | | 6105 |
| RED | 616 | | 6106 |
| DARK RED | 617 | | 6107 |
| LAVENDER | 618 | | 6108 |
| PURPLE | 619 | | 6109 |
| LIGHT BLEND | 620 | | 6110 |
| BRONZE | 621 | | 6111 |
| FLAME | 622 | | 6112 |
| DARK BLEND | 623 | | 6113 |
| VARIEGATED | 624 | | 6114 |
| BI-COLORED | 625 | | 6115 |

Entries in each color and each category; single bloom or 3 blooms, (potentially 30 categories), will be judged for first and second place ribbons. Each first place in the two categories (1 Bloom or 3 Blooms) will be judged to be the best in the category and receive a Gold Ribbon (2 Gold Ribbons). Both gold ribbons will go to the head table and will receive a Red Rosette for Best Single or Best 3 blooms.

SECTION 9

Open to All POMPON

Pompons: Up to 2" (5cm) in diameter

· Three Blooms must be one variety, and in one container

| COLOR | 1 BLOOM | 3 BLOOMS | ADS CLASSIFICATION |
|--------------|----------------|-----------------|---------------------------|
| WHITE | 631 | 645 | 6201 |
| YELLOW | 632 | | 6202 |
| ORANGE | 633 | | 6203 |
| PINK | 634 | | 6204 |
| DARK PINK | 635 | | 6205 |
| RED | 636 | | 6206 |
| DARK RED | 637 | | 6207 |
| LAVENDER | 638 | | 6208 |
| PURPLE | 639 | | 6209 |
| LIGHT BLEND | 640 | | 6210 |
| BRONZE | 641 | | 6211 |
| FLAME | 642 | | 6212 |
| DARK BLEND | 642 | | 6213 |
| VARIEGATED | 643 | | 6214 |
| BI-COLORED | 644 | | 6215 |

Entries in each color and each category; single bloom or 3 blooms, (potentially 30 categories), will be judged for first and second place ribbons. Each first place in the two categories (1 Bloom or 3 Blooms) will be judged to be the best in the category and receive a Gold Ribbon (2 Gold Ribbons). Both gold ribbons will go to the head table and will receive a Red Rosette for Best Single or Best 3 blooms.

SECTION 10

Open to All Stellar

· Three Blooms must be one variety, and in one container

| COLOR | 1 BLOOM | 3 BLOOMS | ADS CLASSIFICATION |
|--------------|----------------|-----------------|---------------------------|
| WHITE | 701 | 716 | 7001 |
| YELLOW | 702 | | 7002 |
| ORANGE | 703 | | 7003 |
| PINK | 704 | | 7004 |
| DARK PINK | 705 | | 7005 |
| RED | 706 | | 7006 |
| DARK RED | 707 | | 7007 |
| LAVENDER | 708 | | 7008 |
| PURPLE | 709 | | 7009 |
| LIGHT BLEND | 710 | | 7010 |
| BRONZE | 711 | | 7011 |
| FLAME | 712 | | 7012 |
| DARK BLEND | 713 | | 7013 |
| VARIEGATED | 714 | | 7014 |
| BI-COLORED | 715 | | 7015 |

Entries in each color and each category; single bloom or 3 blooms, (potentially 30 categories), will be judged for first and second place ribbons. Each first place in the two categories (1 Bloom or 3 Blooms) will be judged to be the best in the category and receive a Gold Ribbon (2 Gold Ribbons). Both gold ribbons will go to the head table and will receive a Red Rosette for Best Single or Best 3 blooms.

Section 11

Open to All WATERLILY

· Three Blooms must be one variety, and in one container

| COLOR | 1 BLOOM | 3 BLOOMS | ADS CLASSIFICATION |
|-------------|---------|----------|--------------------|
| WHITE | 731 | 746 | 7301 |
| YELLOW | 732 | | 7302 |
| ORANGE | 733 | | 7303 |
| PINK | 734 | | 7304 |
| DARK PINK | 735 | | 7305 |
| RED | 736 | | 7306 |
| DARK RED | 737 | | 7307 |
| LAVENDER | 738 | | 7308 |
| PURPLE | 739 | | 7309 |
| LIGHT BLEND | 740 | | 7310 |
| BRONZE | 741 | | 7311 |
| FLAME | 742 | | 7312 |
| DARK BLEND | 743 | | 7313 |
| VARIEGATED | 744 | | 7314 |
| BI-COLORED | 745 | | 7315 |

Entries in each color and each category; single bloom or 3 blooms, (potentially 30 categories), will be judged for first and second place ribbons. Each first place in the two categories (1 Bloom or 3 Blooms) will be judged to be the best in the category and receive a Gold Ribbon (2 Gold Ribbons). Both gold ribbons will go to the head table and will receive a Red Rosette for Best Single or Best 3 blooms.

SECTION 12

Open to all PEONY

· Three Blooms must be one variety, and in one container

| COLOR | 1 BLOOM | 3 BLOOMS | ADS CLASSIFICATION |
|--------------|----------------|-----------------|---------------------------|
| WHITE | 801 | 816 | 8001 |
| YELLOW | 802 | | 8002 |
| ORANGE | 803 | | 8003 |
| PINK | 804 | | 8004 |
| DARK PINK | 805 | | 8005 |
| RED | 806 | | 8006 |
| DARK RED | 807 | | 8007 |
| LAVENDER | 808 | | 8008 |
| PURPLE | 809 | | 8009 |
| LIGHT BLEND | 810 | | 8010 |
| BRONZE | 811 | | 8011 |
| FLAME | 812 | | 8012 |
| DARK BLEND | 813 | | 8013 |
| VARIEGATED | 814 | | 8014 |
| BI-COLORED | 815 | | 8015 |

Entries in each color and each category; single bloom or 3 blooms, (potentially 30 categories), will be judged for first and second place ribbons. Each first place in the two categories (1 Bloom or 3 Blooms) will be judged to be the best in the category and receive a Gold Ribbon (2 Gold Ribbons). Both gold ribbons will go to the head table and will receive a Red Rosette for Best Single or Best 3 blooms.

SECTION 13

Open to all Anemone

· Three Blooms must be one variety, and in one container

| COLOR | 1 BLOOM | 3 BLOOMS | ADS CLASSIFICATION |
|--------------|----------------|-----------------|---------------------------|
| WHITE | 821 | 836 | 8201 |
| YELLOW | 822 | | 8202 |
| ORANGE | 823 | | 8203 |
| PINK | 824 | | 8204 |
| DARK PINK | 825 | | 8205 |
| RED | 826 | | 8206 |
| DARK RED | 827 | | 8207 |
| LAVENDER | 828 | | 8208 |
| PURPLE | 829 | | 8209 |
| LIGHT BLEND | 830 | | 8210 |
| BRONZE | 831 | | 8211 |
| FLAME | 832 | | 8212 |
| DARK BLEND | 833 | | 8213 |
| VARIEGATED | 834 | | 8214 |
| BI-COLORED | 835 | | 8215 |

Entries in each color and each category; single bloom or 3 blooms, (potentially 30 categories), will be judged for first and second place ribbons. Each first place in the two categories (1 Bloom or 3 Blooms) will be judged to be the best in the category and receive a Gold Ribbon (2 Gold Ribbons). Both gold ribbons will go to the head table and will receive a Red Rosette for Best Single or Best 3 blooms.

SECTION 14

Novelty Open NO

.Three Blooms must be one variety, and in one container

| COLOR | 1 BLOOM | 3 BLOOMS | ADS CLASSIFICATION |
|--------------|--------------------|---------------------|-------------------------------|
| WHITE | 861 | 876 | 8601 |
| YELLOW | 862 | | 8602 |
| ORANGE | 863 | | 8603 |
| PINK | 864 | | 8604 |
| DARK PINK | 865 | | 8605 |
| RED | 866 | | 8606 |
| DARK RED | 867 | | 8607 |
| LAVENDER | 868 | | 8608 |
| PURPLE | 869 | | 8609 |
| LIGHT BLEND | 870 | | 8610 |
| BRONZE | 871 | | 8611 |
| FLAME | 872 | | 8612 |
| DARK BLEND | 873 | | 8613 |
| VARIEGATED | 874 | | 8614 |
| BI-COLORED | 875 | | 8615 |

Entries in each color and each category; single bloom or 3 blooms, (potentially 30 categories), will be judged for first and second place ribbons. Each first place in the two categories (1 Bloom or 3 Blooms) will be judged to be the best in the category and receive a Gold Ribbon (2 Gold Ribbons). Both gold ribbons will go to the head table and will receive a Red Rosette for Best Single or Best 3 blooms.

SECTION 15

Open to all Collarette

· Three Blooms must be one variety, and in one container

| COLOR | 1 BLOOM | 3 BLOOMS | ADS CLASSIFICATION |
|--------------|----------------|-----------------|---------------------------|
| WHITE | 901 | 916 | 9001 |
| YELLOW | 902 | | 9002 |
| ORANGE | 903 | | 9003 |
| PINK | 904 | | 9004 |
| DARK PINK | 905 | | 9005 |
| RED | 906 | | 9006 |
| DARK RED | 907 | | 9007 |
| LAVENDER | 908 | | 9008 |
| PURPLE | 909 | | 9009 |
| LIGHT BLEND | 910 | | 9010 |
| BRONZE | 911 | | 9011 |
| FLAME | 912 | | 9012 |
| DARK BLEND | 913 | | 9013 |
| VARIEGATED | 914 | | 9014 |
| BI-COLORED | 915 | | 9015 |

Entries in each color and each category; single bloom or 3 blooms, (potentially 30 categories), will be judged for first and second place ribbons. Each first place in the two categories (1 Bloom or 3 Blooms) will be judged to be the best in the category and receive a Gold Ribbon (2 Gold Ribbons). Both gold ribbons will go to the head table and will receive a Red Rosette for Best Single or Best 3 blooms.

SECTION 16

Open to all Orchid

· Three Blooms must be one variety, and in one container

| COLOR | 1 BLOOM | 3 BLOOMS | ADS CLASSIFICATION |
|--------------|----------------|-----------------|---------------------------|
| WHITE | 921 | 936 | 9201 |
| YELLOW | 922 | | 9202 |
| ORANGE | 923 | | 9203 |
| PINK | 924 | | 9204 |
| DARK PINK | 925 | | 9205 |
| RED | 926 | | 9206 |
| DARK RED | 927 | | 9207 |
| LAVENDER | 928 | | 9208 |
| PURPLE | 929 | | 9209 |
| LIGHT BLEND | 930 | | 9210 |
| BRONZE | 931 | | 9211 |
| FLAME | 932 | | 9212 |
| DARK BLEND | 933 | | 9213 |
| VARIEGATED | 934 | | 9214 |
| BI-COLORED | 935 | | 9215 |

Entries in each color and each category; single bloom or 3 blooms, (potentially 30 categories), will be judged for first and second place ribbons. Each first place in the two categories (1 Bloom or 3 Blooms) will be judged to be the best in the category and receive a Gold Ribbon (2 Gold Ribbons). Both gold ribbons will go to the head table and will receive a Red Rosette for Best Single or Best 3 blooms.

SECTION 17

Open to all Orchette

· Three Blooms must be one variety, and in one container

| COLOR | 1 BLOOM | 3 BLOOMS | ADS CLASSIFICATION |
|--------------|----------------|-----------------|---------------------------|
| WHITE | 941 | 956 | 9401 |
| YELLOW | 942 | | 9402 |
| ORANGE | 943 | | 9403 |
| PINK | 944 | | 9404 |
| DARK PINK | 945 | | 9405 |
| RED | 946 | | 9406 |
| DARK RED | 947 | | 9407 |
| LAVENDER | 948 | | 9408 |
| PURPLE | 949 | | 9409 |
| LIGHT BLEND | 950 | | 9410 |
| BRONZE | 951 | | 9411 |
| FLAME | 952 | | 9412 |
| DARK BLEND | 953 | | 9413 |
| VARIEGATED | 954 | | 9414 |
| BI-COLORED | 955 | | 9415 |

Entries in each color and each category; single bloom or 3 blooms, (potentially 30 categories), will be judged for first and second place ribbons. Each first place in the two categories (1 Bloom or 3 Blooms) will be judged to be the best in the category and receive a Gold Ribbon (2 Gold Ribbons). Both gold ribbons will go to the head table and will receive a Red Rosette for Best Single or Best 3 blooms.

SECTION 18

Open to all Single

· Three Blooms must be one variety, and in one container

| COLOR | 1 BLOOM | 3 BLOOMS | ADS CLASSIFICATION |
|--------------|----------------|-----------------|---------------------------|
| WHITE | 961 | 976 | 9601 |
| YELLOW | 962 | | 9602 |
| ORANGE | 963 | | 9603 |
| PINK | 964 | | 9604 |
| DARK PINK | 965 | | 9605 |
| RED | 966 | | 9606 |
| DARK RED | 967 | | 9607 |
| LAVENDER | 968 | | 9608 |
| PURPLE | 969 | | 9609 |
| LIGHT BLEND | 970 | | 9610 |
| BRONZE | 971 | | 9611 |
| FLAME | 972 | | 9612 |
| DARK BLEND | 973 | | 9613 |
| VARIEGATED | 974 | | 9614 |
| BI-COLORED | 975 | | 9615 |

Entries in each color and each category; single bloom or 3 blooms, (potentially 30 categories), will be judged for first and second place ribbons. Each first place in the two categories (1 Bloom or 3 Blooms) will be judged to be the best in the category and receive a Gold Ribbon (2 Gold Ribbons). Both gold ribbons will go to the head table and will receive a Red Rosette for Best Single or Best 3 blooms.

SECTION 19

Open to all Mignon Single

· Three Blooms must be one variety, and in one container

| COLOR | 1 BLOOM | 3 BLOOMS | ADS CLASSIFICATION |
|--------------|----------------|-----------------|---------------------------|
| WHITE | 971 | 986 | 9701 |
| YELLOW | 972 | | 9702 |
| ORANGE | 973 | | 9703 |
| PINK | 974 | | 9704 |
| DARK PINK | 975 | | 9705 |
| RED | 976 | | 9706 |
| DARK RED | 977 | | 9707 |
| LAVENDER | 978 | | 9708 |
| PURPLE | 979 | | 9709 |
| LIGHT BLEND | 980 | | 9710 |
| BRONZE | 981 | | 9711 |
| FLAME | 982 | | 9712 |
| DARK BLEND | 983 | | 9713 |
| VARIEGATED | 984 | | 9714 |
| BI-COLORED | 985 | | 9715 |

Entries in each color and each category; single bloom or 3 blooms, (potentially 30 categories), will be judged for first and second place ribbons. Each first place in the two categories (1 Bloom or 3 Blooms) will be judged to be the best in the category and receive a Gold Ribbon (2 Gold Ribbons). Both gold ribbons will go to the head table and will receive a Red Rosette for Best Single or Best 3 blooms.

SECTION 20

Open to all Novelty Double Center

· Three Blooms must be one variety, and in one container

| COLOR | 1 BLOOM | 3 BLOOMS | ADS CLASSIFICATION |
|-------------|---------|----------|--------------------|
| WHITE | 761 | 776 | 7601 |
| YELLOW | 762 | | 7602 |
| ORANGE | 763 | | 7603 |
| PINK | 764 | | 7604 |
| DARK PINK | 765 | | 7605 |
| RED | 766 | | 7606 |
| DARK RED | 767 | | 7607 |
| LAVENDER | 768 | | 7608 |
| PURPLE | 769 | | 7609 |
| LIGHT BLEND | 770 | | 7610 |
| BRONZE | 771 | | 7611 |
| FLAME | 772 | | 7612 |
| DARK BLEND | 773 | | 7613 |
| VARIEGATED | 774 | | 7614 |
| BI-COLORED | 775 | | 7615 |

Entries in each color and each category; single bloom or 3 blooms, (potentially 30 categories), will be judged for first and second place ribbons. Each first place in the two categories (1 Bloom or 3 Blooms) will be judged to be the best in the category and receive a Gold Ribbon (2 Gold Ribbons). Both gold ribbons will go to the head table and will receive a Red Rosette for Best Single or Best 3 blooms.

Section 21

Open to all Micro Blooms (not including Pompons)

| | |
|------------------------------------|----|
| Single Micro (any form or color) | 98 |
| 3 Blooms Micro (any form or color) | 99 |

SECTION 22

ADS Seedling Bench EVALUATION

Open to 1st, 2nd, 3rd and 4th Year Seedlings

A.D.S. Seedling Bench Evaluation

Offered in cooperation with The American Dahlia Society

1. A separate Section identified as the A.D.S. Seedling Section will be provided by the Show Officials. To be eligible for entry in this Section, the variety must be 3 or more years old.
2. No charge for entry in the A.D.S. Seedling Evaluation Section, nor requirement of membership in a local society may be imposed on an exhibitor for entering this class.
3. No variety is eligible for entry in the A.D.S. Seedling Evaluation Section for more than 2 consecutive years, and if entered into this section contrary to this provision, its most recent scores will be discarded.
4. If any entry receives a score of 85 points or more, it must be named immediately in accordance with the rules of the Classification Committee as outlined in Article IX, Section 8, Clause 2 of the BYLAWS of the American Dahlia Society, Inc.
5. Name and address of the originator and name or number of the variety must appear legibly on the entry tag.
6. Not more than one entry of a variety may be made, but there is no limit on the number of varieties that may be entered. Varieties entered may be grown by the originator or his representative.
7. All entries must be judged by at least two Senior A.D.S. Judges, and not more than two Accredited A.D.S. Judges, provided that at least three judges participate in scoring of each variety, and that the number of Senior A.D.S. Judges outnumbers the Accredited A.D.S. Judges.
8. If a variety shows evidence of disease or if in the opinion of the Judges an entry is not deemed worthy, it should be eliminated from scoring. A notation on the entry tag should be made as to why the entry was not scored.
9. Judges' scores, which vary by 3 points or more from the average of the scores of the majority of judges, either higher or lower, must be discarded and the average of the remaining scores will prevail.
10. No exhibitor in the section may judge an entry.

SECTION 22

(CONTINUED)

Open to 1st 2nd 3rd and 4th + Year Seedlings

11. Each entry scoring 85 points or more will receive an A.D.S. Seedling Award Ribbon.
12. The entry with the highest average of any variety over 85 points will receive an A.D.S. Achievement Award Ribbon. In case of a tie, the judges must decide which variety possesses the greatest and most outstanding distinction over similar standard varieties.
13. The Chairman of the A.D.S. Seedling Evaluation will annually certify to originators the score, or scores achieved by their dahlias during the current year bench evaluation.
14. A Gold Medal Certificate will be presented to the originators of those varieties which have received three scores of 85 points or more in bench scoring at shows held by three different societies and 85 points or more in three different trial grounds. To be eligible to receive this award, such scores must be earned in a consecutive 2-year period but may be earned in one year.
15. The receipt of the Gold Medal Certificate will be construed as a pledge by the originator to introduce the variety the following year. No certificate will be awarded unless the variety is introduced accordingly. Any variety having scored 85 points or more at one show will be considered a disseminated variety the second year.
16. A LYNN B. DUDLEY MEDAL will be awarded to the GOLD MEDAL CERTIFICATE winner which has the highest average bench score as an A, B, BB, Miniature, or any other type. The highest three scores earned in accordance with the entry under Rule 3, shall be used to determine such highest averages. In the case of ties, duplicate awards will be made.
17. The Seedling Bench Evaluation will proceed under the rules of The American Dahlia Society, Inc. as published in the latest issue of the Classification and Handbook of Dahlias.

Seedlings

| | | |
|-----------|----------------|-------------------------|
| Class 796 | 1st Year | One Bloom |
| Class 797 | 2nd & 3rd Year | One Bloom |
| Class 798 | 4th Year | 3 Blooms/ One Container |

SECTION 23

VASES - Dahlias

- VASE - A vessel for displaying flowers. Its height is greater than the diameter of its mouth.
- A vase is judged mainly on the quality of the flowers included, not on the arrangement of the flowers
- Natural foliage may be used
- No oasis, raffia or floral frogs allowed in vase

| | |
|-----------|---|
| Class 100 | Vase of 5 blooms, 'B' and 'BB' size, any color |
| Class 102 | Vase of any number of blooms, Ball and Min Ball size, any color |
| Class 103 | Vase of any type, excluding above, any number, and any size |
| Class 104 | Mixed vase of 5 dahlias, any size, any color |
| Class 105 | Mixed vase of 6 or more dahlias all one color |

BEST ENTRIES for Intermediate and Open:

Each of the 5 classes receive a first or second ribbon and then all the first-place ribbons will be judged to receive a gold ribbon and go to the head table to receive a red rosette; one for open and one for intermediate.

SECTION 24

BASKETS - Dahlias

- Natural foliage may be used
- Baskets may contain more than one variety
- Baskets judged from one side only
- A floral design is successful when the elements of design are applied to the principles of design producing beauty, harmony, distinction and expression
- Baskets must have a handle

| | |
|-----------|---|
| Class 200 | Basket of 'B' or 'BB' size blooms - 7 or more |
| Class 201 | Basket of Mini ball or Ball size blooms - 9 or more |
| Class 202 | Basket of any size blooms, excluding above - any number of blooms (Primarily Dahlias) |
| Class 203 | Basket of any type, any size blooms, any number, other flowers included |

Each of the 4 classes receive a first or second ribbon and then all the first place ribbons will be judged to receive a gold ribbon and go to the head table to receive a red rosette; one for open and one for intermediate.

Section 25

Special Memorial Awards

| | |
|-----------|---|
| Class 205 | Best "Pooh" Dahlia (single) in memory of Harvey Knutson |
| Class 206 | Best vase of red and/or white dahlias in memory of Jeannie Carter |
| Class 207 | Table Centre arrangement using primarily "Alberta" Dahlias in memory of Wayne Roberts |

***A rosette will be given to each Special Award winner.**

Past Memorial Awards (Retired with Love)

- Tony Jensen (Best Zorro)
- Ernie Henderson (Best Regal Rose)
- June Quintilio (Best vase of purple flowers)
- Dave Dillabough (Best glads in an antique container)
- Andy Krajewski (Best Gladiolus, any size or Colour)

SECTION 26

ARRANGEMENTS

- Predominately Dahlias.
- **Any foliage or accessories can be used**
- A floral design is successful when the elements of design are applied to the principles of design producing beauty, harmony, distinction and expression

| | |
|-----------|--|
| Class 300 | In memory of the Pandemic of 2020-2021, Primarily Dahlias. |
| Class 301 | Arrangement (your choice of style) celebrating the United Nations International year of Peace and Trust. Can be any flowers. |
| Class 302 | Arrangement using four forms of dahlias with at least six colors, Your choice of style of arrangement. |
| Class 303 | Novelty arrangement using primarily Dahlias |
| Class 304 | Novelty arrangement with theme: "Breakfast" accessories encouraged. |

Each of the 5 classes receive a first or second ribbon and then all the first place ribbons will be judged to receive a gold ribbon and go to the head table to receive a red rosette; one for open and one for intermediate.

SECTION 27

DAHLIA IN A BOWL

- Any size dahlia may be used
- The container may be flat or on a pedestal and viewed from the top, or, if container is clear, from top or side
- No artificial (floral) shall be used
- Unattached foliage may be used
- All dahlias and flowers must be inside the bowl

| | |
|-----------|-------------------------|
| Class 400 | One dahlia in a bowl |
| Class 401 | Three dahlias in a bowl |

Winner of each of the two categories receives a gold ribbon and go to the head table; one for open and one for intermediate.

GLADIOLUS CLASSES

Floret Size Classification

| | | |
|-----|-----------|-----------------------|
| 100 | Miniature | Florets under 2½" |
| 200 | Small | Florets 2½" to 3½" |
| 300 | Medium | Florets 3½" to 4½" |
| 400 | Large | Florets 4½" to 5½" |
| 500 | Giant | Florets 5½" or larger |

Color Classification

| Color | Pale | Light | Medium | | |
|----------|--------|--------|--------|----|---------------|
| White | 00 | | | | |
| Green | | 02 | 04 | 06 | |
| Yellow | 10*(1) | 12 | 14 | 16 | |
| Orange | 20*(2) | 22 | 24 | 26 | |
| Salmon | 30 | 32 | 34 | 36 | |
| Pink | 40 | 42 | 44 | 46 | |
| Red | | 52*(4) | 54 | 56 | 58 Black Red |
| Rose | 60 | 62 | 64 | 66 | 68 Black Rose |
| Lavender | 70 | 72 | 74 | 76 | 78 Purple |
| Violet | 80 | 82 | 84 | 86 | |
| Smokies | 90 | 92 | 94 | 96 | |
| Tan | 90 | | | | 98 Brown |

SECTION 28

GLADS

Class 400-500

Florets 4½" (12cm) and up One Spike

| | | |
|-----|------------------|----------|
| 101 | White | 00 to 01 |
| 102 | Green | 02 to 07 |
| 103 | Cream | 10 to 11 |
| 104 | Yellow | 12 to 17 |
| 105 | Orange | 20 to 27 |
| 106 | Lt Salmon | 30 to 33 |
| 107 | Dk Salmon | 34 to 37 |
| 108 | Pale to Lt Pink | 40 to 43 |
| 109 | Dk Pink | 44 to 47 |
| 110 | Red | 50 to 57 |
| 111 | Black Red | 58 to 59 |
| 112 | Pale to Med Rose | 60 to 65 |
| 113 | Deep to Dk Rose | 66 to 69 |
| 114 | Lavender | 70 to 77 |
| 115 | Purple | 78 to 79 |
| 116 | Violet | 80 to 87 |
| 117 | Smokey | 90 to 99 |

Each of the 17 classes receive a first or second ribbon and then all the first-place ribbons will be judged to receive a gold ribbon and the one Gold Ribbon will go to the head table to receive a red rosette; one for open and one for intermediate.

SECTION 29

GLADS

Class 300

Florets 3½" - 4½" (9cm-12cm) One Spike

| | | |
|-----|----------------|----------|
| 118 | White | 00 to 01 |
| 119 | Green, Cream | 02 to 11 |
| 120 | Yellow | 12 to 17 |
| 121 | Orange | 20 to 27 |
| 122 | Salmon | 30 to 37 |
| 123 | Pink | 40 to 47 |
| 124 | Red | 50 to 59 |
| 125 | Rose | 60 to 69 |
| 126 | Lavender | 70 to 77 |
| 127 | Purple, Violet | 78 to 87 |
| 128 | Smokey | 90 to 99 |

Each of the 11 classes receive a first or second ribbon and then all the first place ribbons will be judged to receive a gold ribbon and the one gold ribbon will go to the head table to receive a red rosette; one for open and one for intermediate,

SECTION 30

GLADS

Class 200-100

Florets under 3½" (9cm) One Spike

| | | |
|-----|----------------|----------|
| 129 | White | 00 to 01 |
| 130 | Green, Cream | 02 to 11 |
| 131 | Yellow | 12 to 17 |
| 132 | Orange | 20 to 27 |
| 133 | Salmon | 30 to 37 |
| 134 | Pink | 40 to 47 |
| 135 | Red | 50 to 59 |
| 136 | Rose | 60 to 69 |
| 137 | Lavender | 70 to 77 |
| 138 | Purple, Violet | 78 to 87 |
| 139 | Smokey | 90 to 99 |

Each of the 11 classes receive a first or second ribbon and then all the first-place ribbons will be judged to receive a gold ribbon and the one gold ribbon will go to the head table to receive a red rosette; one for open and one for intermediate,

SECTION 31

GLADS

Class - Seedling

| | | | |
|-----|---------|-------------------------|-------------|
| 140 | 1 spike | Large size (400 to 500) | Dark Color |
| 141 | 1 spike | Large size (400 to 500) | Light Color |
| 142 | 1 spike | Med Size (300) | Any Color |
| 143 | 1 spike | Med Size (200 to 100)) | Any Color |

Each of the 4 classes receive a first or second ribbon and then all the first-place ribbons will be judged to receive a gold ribbon and the one gold ribbon will go to the head table to receive a red rosette: one for open and one for intermediate,

SECTION 32

GLADS – 3 SPIKES

Class 400-500 - Three Spike, Separate Containers
Florets 4½" (12cm) and up

| | | |
|-----|--------------|----------|
| 144 | White | 00 to 01 |
| 145 | Green, Cream | 02 to 11 |
| 146 | Yellow | 12 to 17 |
| 147 | Orange | 20 to 27 |
| 148 | Salmon | 30 to 37 |
| 149 | Pink | 40 to 47 |
| 150 | Red | 50 to 59 |
| 151 | Rose | 60 to 69 |
| 152 | Lavender | 70 to 77 |
| 153 | Purple | 78 to 79 |
| 154 | Violet | 80 to 87 |
| 155 | Smokey | 90 to 99 |

Each of the 12 classes receive a first or second ribbon and then all the first-place ribbons will be judged to receive a gold ribbon and the one gold ribbon will go to the head table to receive a red rosette; one for open and one for intermediate.

SECTION 33

GLADS – 3 Spikes

Class 300

Florets 3½" - 4½" (9cm-12cm) Three Spike, Separate Containers

| | | |
|-----|--------------|----------|
| 156 | White | 00 to 01 |
| 157 | Green, Cream | 02 to 11 |
| 158 | Yellow | 12 to 17 |
| 159 | Orange | 20 to 27 |
| 160 | Salmon | 30 to 37 |
| 161 | Pink | 40 to 47 |
| 162 | Red | 50 to 59 |
| 163 | Rose | 60 to 67 |
| 164 | Lavender | 70 to 77 |
| 165 | Purple | 78 to 79 |
| 166 | Violet | 80 to 87 |
| 167 | Smokey | 90 to 99 |

Each of the 12 classes receive a first or second ribbon and then all the first-place ribbons will be judged to receive a gold ribbon and the one gold ribbon will go to the head table to receive a red rosette; one for open and one for intermediate.

SECTION 34

GLADS - 3 Spikes

Class 200-100

Florets under 3½" (9cm) Three Spike, Separate Containers

| | | |
|-----|--------------|----------|
| 168 | White | 00 to 01 |
| 169 | Green, Cream | 02 to 11 |
| 170 | Yellow | 12 to 17 |
| 171 | Orange | 20 to 27 |
| 172 | Salmon | 30 to 37 |
| 173 | Pink | 40 to 47 |
| 174 | Red | 50 to 59 |
| 175 | Rose | 60 to 69 |
| 176 | Lavender | 70 to 77 |
| 177 | Purple | 78 to 79 |
| 178 | Violet | 80 to 87 |
| 179 | Smokey | 90 to 99 |

Each of the 12 classes receive a first or second ribbon and then all the first-place ribbons will be judged to receive a gold ribbon and the one gold ribbon will go to the head table to receive a red rosette; one for open and one for intermediate.

SECTION 35

GLAD VASES

Vases

- Natural foliage may be used

| Class | | | |
|--------------|------------------------------------|-------------|----------------|
| 180 | Min of 6 spikes | One variety | 400 - 500 size |
| 181 | Min of 6 spikes | One variety | 300 size |
| 182 | Min of 6 spikes | One variety | 200 - 100 size |
| 183 | Any number | Any variety | |
| 184 | Mixed glads with any other flowers | | |

Each of the 5 classes receive a first or second ribbon and then all the first-place ribbons will be judged to receive a gold ribbon and the one gold ribbon will go to the head table to receive a red rosette; one for open and one for intermediate

SECTION 36

GLAD BASKETS

- Natural foliage may be used
- Baskets judged from one side only
- A floral design is successful when the elements of design are applied to the principles of design producing beauty, harmony, distinction and expression.
- Baskets must have a handle

| Class | | | |
|-------|------------|--------------------------------|----------------|
| 184 | Any number | One variety | 400 - 500 size |
| 185 | Any number | One variety | 300 sizes |
| 186 | Any number | One variety | 200 - 100 size |
| 187 | Any number | Any variety | |
| 188 | Any number | Any variety with other flowers | |

Each of the 5 classes receive a first or second ribbon and then all the first-place ribbons will be judged to receive a gold ribbon and the one gold ribbon will go to the head table to receive a red rosette; one for open and one for intermediate

Section 37

GLAD ARRANGEMENTS

| | |
|-----------|---|
| Class 189 | Arrangement (buffet style) celebrating the Calgary Stampede's Football club 75th Anniversary (Primarily glads). |
| Class 190 | Your choice arrangement, any theme, primarily glad, provide a theme card explaining your arrangement |
| Class 191 | Novelty arrangement, primarily glads. |
| Class 192 | Arrangement (your choice of style) "Birds of a Feather", Primarily Glads. |
| Class 193 | Arrangement (your choice of style) "Rocky Mountain High", primarily glads. |

Section 38

Western International Added Classes

(For Glad Seedlings only)

| Class | | |
|--------------|--|------------------|
| 194 | Ed Squire's Award* | 3-Spike Seedling |
| 195 | Decorative large single spike | 300 - 500 size |
| 196 | Decorative small single spike | 200 - 100 size |
| 197 | Decorative Three-Spike | 100 - 500 size |
| | * Note: the winning entry must score 85 to qualify for the award | |

Gladiolus Head Table Awards

(Large Purple Rosettes)

Open Exhibitor Class

1. Grand Champion Exhibition Spike
2. Reserve Grand Champion Exhibition Spike
3. Grand Champion Decorative Spike
4. Reserve Grand Champion Decorative Spike

Intermediate Exhibitor Class

1. Grand Champion Exhibition Spike
2. Reserve Grand Champion Exhibition Spike
3. Grand Champion Decorative Spike
4. Reserve Grand Champion Decorative Spike

Gladiolus Special Awards

(Small Red Rosettes)

Open Exhibitors

1. Champion Large Exhibition Spike (400-500) size
2. Champion Medium Exhibition Spike (300) size
3. Champion Small Exhibition Spike (100-200) size
4. Champion Large Decorative Spike (400-500) size
5. Champion Medium Decorative Spike (300) size
6. Champion Small Decorative Spike (100-200) size
7. Champion 3 Spikes
8. Reserve Champion 3 Spikes
9. Champion 5 Spikes (any size, can be different cultivars)
10. Champion Basket of Glads
11. Champion Vase of Glads
12. Champion Arrangement of Glads
13. Most Outstanding Exhibit of Glads
14. Best Exhibition Seedling
15. Best Decorative Seedling
16. Best Single Spike Originated in Canada

Intermediate Exhibitors

17. Champion Large Exhibition Spike (400-500) size
18. Champion Medium Exhibition Spike (300) size
19. Champion Small Exhibition Spike (100-200) size
20. Champion Large Decorative Spike (400-500) size
21. Champion Medium Decorative Spike (300) size
22. Champion Small Decorative Spike (100-200) size
23. Champion 3 Spikes
24. Reserve Champion 3 Spikes
25. Champion 5 Spikes (any size, can be different cultivars)
26. Champion Basket of Glads
27. Champion Vase of Glads
28. Champion Arrangement of Glads
29. Most Outstanding Exhibit of Glads
30. Best Exhibition Seedling
31. Best Decorative Seedling
32. Best Single Spike Originated in Canada

SECTION 38

NAGC PHOTO CONTEST

In 2021 the Red Deer Club was going to host the North American Glad Council (NAGC) and the Canadian Glad Society and we were going to have a photo contest that would be put on display at the show. However, the uncertainty of the pandemic caused us to postpone hosting until 2022 but we decided to go ahead with the photo contest anyways and have it online. There will be a People's Choice winner and the closing date for the photos will be August 15, 2021. Photos 5x7 size can be emailed to debhatt@xplornet.com or given to her at the show.

Terri-Lynne Dodd has graciously volunteered to organize our own photo contest at the annual flower show 2021 and the glad entries (classes 1-8) will be kept and submitted to the NAGC photo contest in the fall. All the entries in Section 38 will be judged and receive ribbons in each category.

| | |
|----------|---|
| Class 1 | The Glad Patch |
| Class 2 | Undisseminated Seedlings |
| Class 3 | Macro View - Glad |
| Class 4 | Glads and Children |
| Class 5 | Glads and Critters |
| Class 6 | At the Show - Glads |
| Class 7 | Glad Personalities (People) |
| Class 8 | Glad Occasions |
| Class 9 | Dahlia Portrait |
| Class 10 | Macro – Dahlia |
| Class 11 | In the Garden - Dahlias |
| Class 12 | Dahlia – Artistic Impression (photoshop ok) |